

Designation system

Dot Matrix LED Display

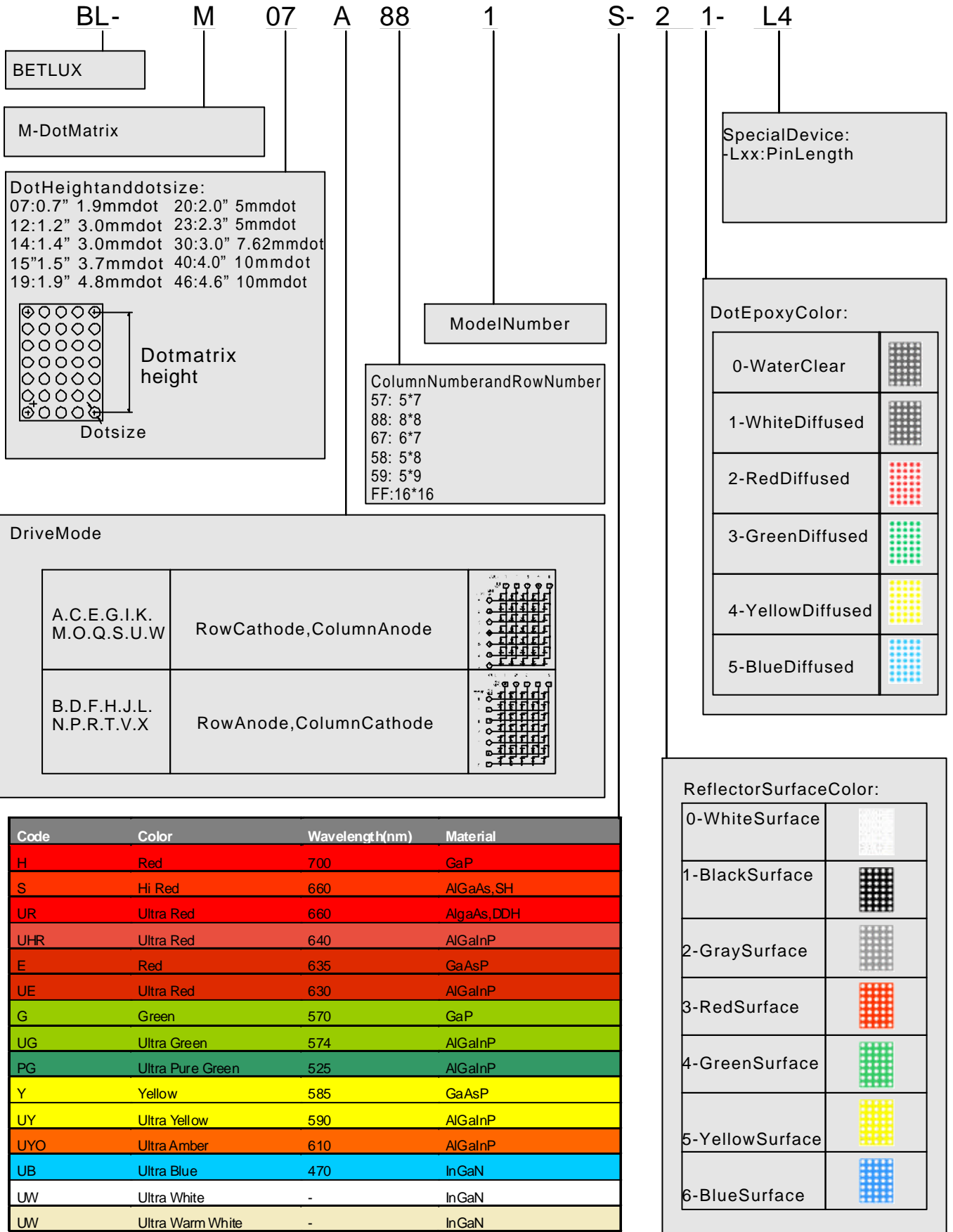

Dot Matrix LED Display

Part No		Chip		λ P (nm)	Typ.	Drawing
CommonCathode	CommonAnode	Material				

BL-M07A571S-XX	BL-M07B571S-XX	GaAlAs/GaAs,SH	█	660	100
BL-M07A571D-XX	BL-M07B571D-XX	GaAlAs/GaAs,DH	█	660	110
BL-M07A571UR-XX	BL-M07B571UR-XX	GaAlAs/GaAs,DDH	█	660	120
BL-M07A571E-XX	BL-M07B571E-XX	GaAsP/GaP	█	635	90
BL-M07A571Y-XX	BL-M07B571Y-XX	GaAsP/GaP	█	585	90
BL-M07A571G-XX	BL-M07B571G-XX	GaP/GaP	█	570	85
BL-M07A571UHR-XX	BL-M07B571UHR-XX	AlGaInP	█	645	120
BL-M07A571UE-XX	BL-M07B571UE-XX	AlGaInP	█	630	100
BL-M07A571YO-XX	BL-M07B571YO-XX	AlGaInP	█	619	100
BL-M07A571UY-XX	BL-M07B571UY-XX	AlGaInP	█	590	100
BL-M07A571UG-XX	BL-M07B571UG-XX	AlGaInP	█	574	130
BL-M07A571PG-XX	BL-M07B571PG-XX	InGaN	█	525	150
BL-M07A571B-XX	BL-M07B571B-XX	InGaN	█	470	70
BL-M07A571W-XX	BL-M07B571W-XX	InGaN	□	/	100

BL-M07C571S-XX	BL-M07D571S-XX	GaAlAs/GaAs,SH	█	660	100
BL-M07C571D-XX	BL-M07D571D-XX	GaAlAs/GaAs,DH	█	660	110
BL-M07C571UR-XX	BL-M07D571UR-XX	GaAlAs/GaAs,DDH	█	660	120
BL-M07C571E-XX	BL-M07D571E-XX	GaAsP/GaP	█	635	90
BL-M07C571Y-XX	BL-M07D571Y-XX	GaAsP/GaP	█	585	90
BL-M07C571G-XX	BL-M07D571G-XX	GaP/GaP	█	570	85
BL-M07C571UHR-XX	BL-M07D571UHR-XX	AlGaInP	█	645	120
BL-M07C571UE-XX	BL-M07D571UE-XX	AlGaInP	█	630	100
BL-M07C571YO-XX	BL-M07D571YO-XX	AlGaInP	█	619	100
BL-M07C571UY-XX	BL-M07D571UY-XX	AlGaInP	█	590	100
BL-M07C571UG-XX	BL-M07D571UG-XX	AlGaInP	█	574	130
BL-M07C571PG-XX	BL-M07D571PG-XX	InGaN	█	525	150
BL-M07C571B-XX	BL-M07D571B-XX	InGaN	█	470	70
BL-M07C571W-XX	BL-M07D571W-XX	InGaN	□	/	100

BL-M07A571SG-XX	BL-M07B571SG-XX	AlGaInP	█	660	100
		GaP/GaP	█	570	95
BL-M07A571EG-XX	BL-M07B571EG-XX	GaAsP/GaP	█	635	90
		GaP/GaP	█	570	95
BL-M07A571DUG-XX	BL-M07B571DUG-XX	AlGaInP	█	660	110
		AlGaInP	█	574	130
BL-M07A571UEUG-XX	BL-M07B571UEUG-XX	AlGaInP	█	630	100
		AlGaInP	█	574	130

BL-M07X571 Series

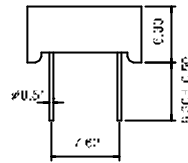
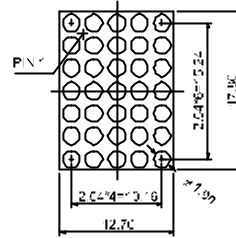

BL-M07A571

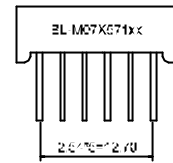
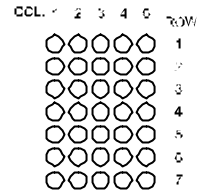

BL-M07B571

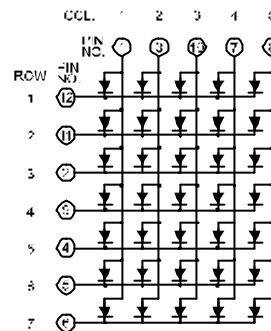

BL-M07C571

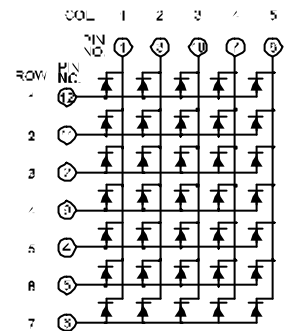

BL-M07D571

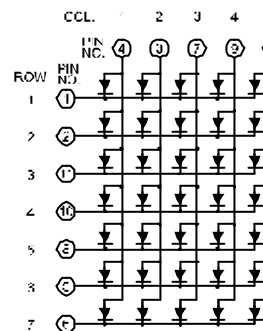

BL-M07A571xx

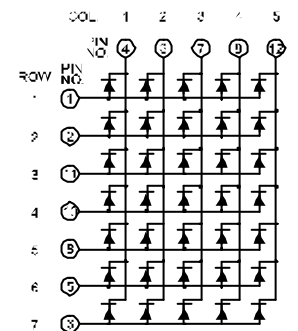

BL-M07B571xx

—▷— = GREEN
—▷— = ORANGE

—▷— = GREEN
—▷— = ORANGE

Dot Matrix LED Display

Part No		Chip		Iv(mcd)	Drawing
CommonCathode	CommonAnode	Material	λ P (nm)	Typ.	

BL-M07A881S-XX	BL-M07B881S-XX	GaAlAs/GaAs,SH		660	200
BL-M07A881D-XX	BL-M07B881D-XX	GaAlAs/GaAs,DH		660	320
BL-M07A881UR-XX	BL-M07B881UR-XX	GaAlAs/GaAs,DDH		660	400
BL-M07A881E-XX	BL-M07B881E-XX	GaAsP/GaP		635	190
BL-M07A881Y-XX	BL-M07B881Y-XX	GaAsP/GaP		585	190
BL-M07A881G-XX	BL-M07B881G-XX	GaP/GaP		570	195
BL-M07A881UHR-XX	BL-M07B881UHR-XX	AlGaInP		645	400
BL-M07A881UE-XX	BL-M07B881UE-XX	AlGaInP		630	235
BL-M07A881YO-XX	BL-M07B881YO-XX	AlGaInP		619	235
BL-M07A881UY-XX	BL-M07B881UY-XX	AlGaInP		590	235
BL-M07A881UG-XX	BL-M07B881UG-XX	AlGaInP		574	250
BL-M07A881PG-XX	BL-M07B881PG-XX	InGaN		525	270
BL-M07A881B-XX	BL-M07B881B-XX	InGaN		470	180
BL-M07A881W-XX	BL-M07B881W-XX	InGaN		/	280

BL-M07X881 Series

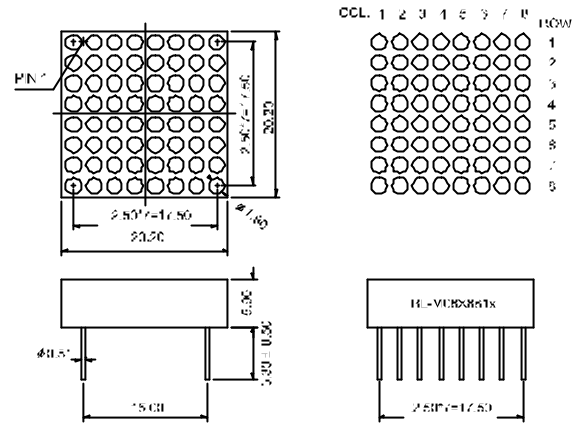

BL-M07A881

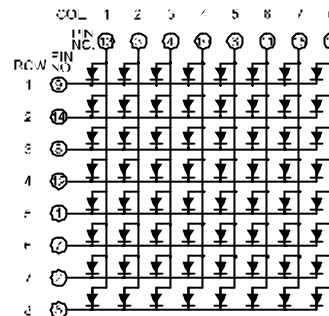

BL-M07B881

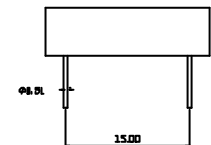
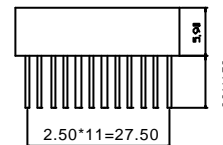
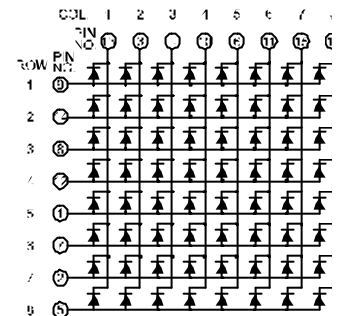

BL-M07A881XX

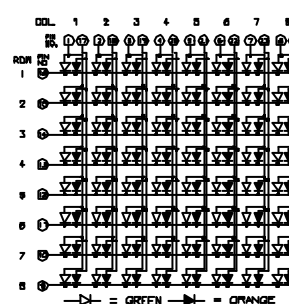

BL-M07B881XX

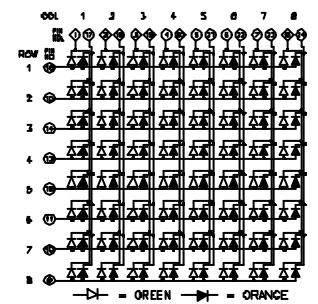

BL-M07A881SG-XX	BL-M07B881SG-XX	AlGaInP		660	200
		GaP/GaP		570	195
BL-M07A881EG-XX	BL-M07B881EG-XX	GaAsP/GaP		635	190
		GaP/GaP		570	195
BL-M07A881DUG-XX	BL-M07B881DUG-XX	AlGaInP		660	320
		AlGaInP		574	250
BL-M07A881UEUG-XX	BL-M07B881UEUG-XX	AlGaInP		630	235
		AlGaInP		574	250

Dot Matrix LED Display

Part No		Chip		Iv(mcd)	Typ.
CommonCathode	CommonAnode	Material	λ P (nm)		

Drawing

BL-M12A571S-XX	BL-M12B571S-XX	GaAlAs/GaAs,SH		660	100
BL-M12A571D-XX	BL-M12B571D-XX	GaAlAs/GaAs,DH		660	110
BL-M12A571UR-XX	BL-M12B571UR-XX	GaAlAs/GaAs,DDH		660	120
BL-M12A571E-XX	BL-M12B571E-XX	GaAsP/GaP		635	90
BL-M12A571Y-XX	BL-M12B571Y-XX	GaAsP/GaP		585	90
BL-M12A571G-XX	BL-M12B571G-XX	GaP/GaP		570	95
BL-M12A571UHR-XX	BL-M12B571UHR-XX	AlGaInP		645	120
BL-M12A571UE-XX	BL-M12B571UE-XX	AlGaInP		630	100
BL-M12A571YO-XX	BL-M12B571YO-XX	AlGaInP		619	100
BL-M12A571UY-XX	BL-M12B571UY-XX	AlGaInP		590	100
BL-M12A571UG-XX	BL-M12B571UG-XX	AlGaInP		574	130
BL-M12A571PG-XX	BL-M12B571PG-XX	InGaN		525	150
BL-M12A571B-XX	BL-M12B571B-XX	InGaN		470	70
BL-M12A571W-XX	BL-M12B571W-XX	InGaN		/	100

BL-M12X571 Series

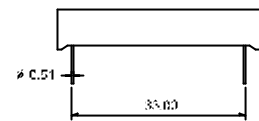
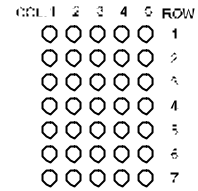
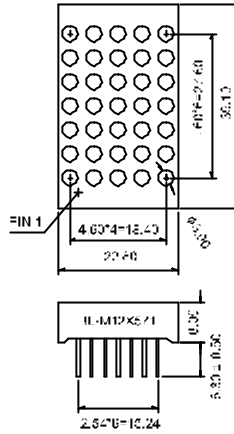

BL-M12A571

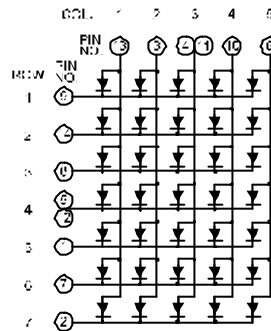

BL-M12B571

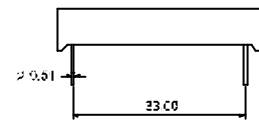
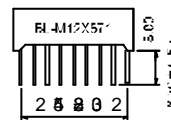
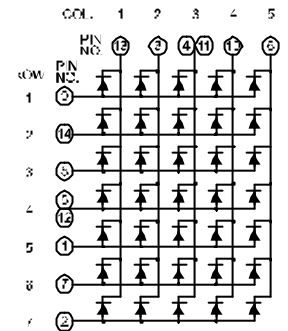

BL-M12A571EG

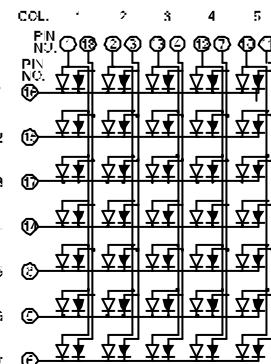

BL-M12B571EG

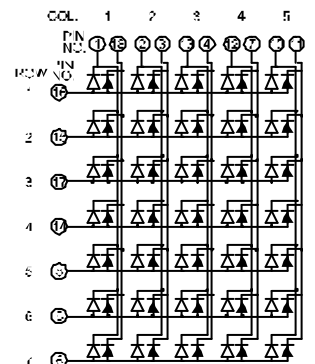

= GREEN
 = ORANGE 3 NO CONNECT

= GREEN
 = ORANGE 3 NO CONNECT

Dot Matrix LED Display

Part No		Chip		λ P (nm)	Typ.
CommonCathode	CommonAnode	Material			
BL-M12A572S-XX	BL-M12B572S-XX	GaAlAs/GaAs,SH	660	100	
BL-M12A572D-XX	BL-M12B572D-XX	GaAlAs/GaAs,DH	660	110	
BL-M12A572UR-XX	BL-M12B572UR-XX	GaAlAs/GaAs,DDH	660	120	
BL-M12A572E-XX	BL-M12B572E-XX	GaAsP/GaP	635	90	
BL-M12A572Y-XX	BL-M12B572Y-XX	GaAsP/GaP	585	90	
BL-M12A572G-XX	BL-M12B572G-XX	GaP/GaP	570	95	
BL-M12A572UHR-XX	BL-M12B572UHR-XX	AlGaInP	645	120	
BL-M12A572UE-XX	BL-M12B572UE-XX	AlGaInP	630	100	
BL-M12A572YO-XX	BL-M12B572YO-XX	AlGaInP	619	100	
BL-M12A572UY-XX	BL-M12B572UY-XX	AlGaInP	590	100	
BL-M12A572UG-XX	BL-M12B572UG-XX	AlGaInP	574	130	
BL-M12A572PG-XX	BL-M12B572PG-XX	InGaN	525	150	
BL-M12A572B-XX	BL-M12B572B-XX	InGaN	470	70	
BL-M12A572W-XX	BL-M12B572W-XX	InGaN	/	100	

Drawing

BL-M12X572 Series

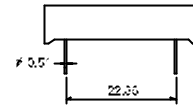
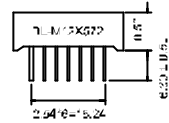
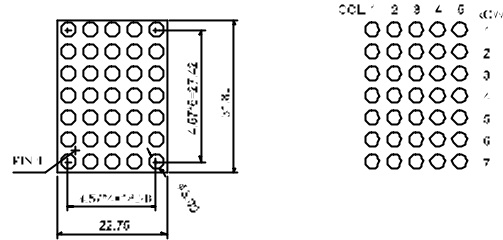

BL-M12A572

BL-M12B572

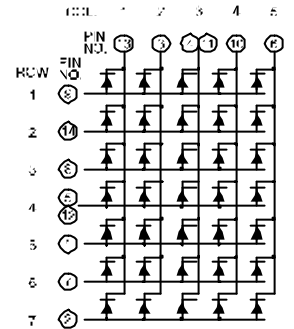
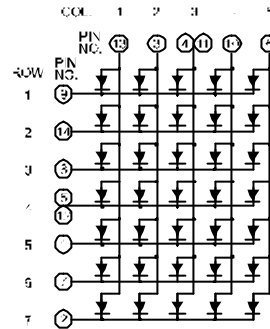

BL-M12X573 Series

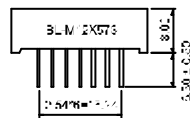
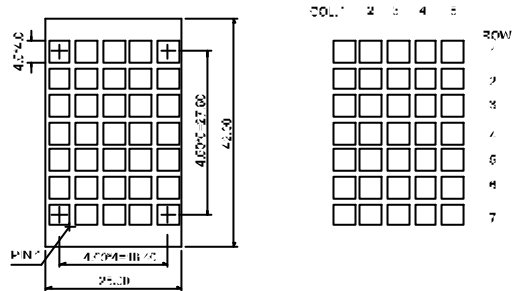

BL-M12A573

BL-M12B573

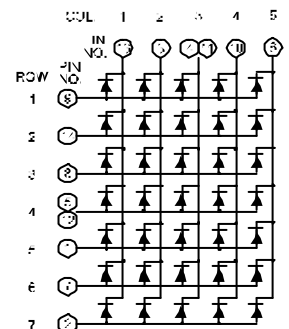
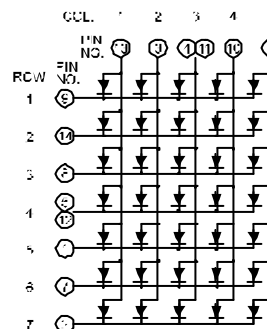

Dot Matrix LED Display

Part No		Chip		Iv(mcd)	Drawing
CommonCathode	CommonAnode	Material	λP (nm)	Typ.	

BL-M12A591S-XX	BL-M12B591S-XX	GaAlAs/GaAs,SH	660	105
BL-M12A591D-XX	BL-M12B591D-XX	GaAlAs/GaAs,DH	660	115
BL-M12A591UR-XX	BL-M12B591UR-XX	GaAlAs/GaAs,DDH	660	125
BL-M12A591E-XX	BL-M12B591E-XX	GaAsP/GaP	635	95
BL-M12A591Y-XX	BL-M12B591Y-XX	GaAsP/GaP	585	95
BL-M12A591G-XX	BL-M12B591G-XX	GaP/GaP	570	100
BL-M12A591UHR-XX	BL-M12B591UHR-XX	AlGaInP	645	125
BL-M12A591UE-XX	BL-M12B591UE-XX	AlGaInP	630	105
BL-M12A591YO-XX	BL-M12B591YO-XX	AlGaInP	619	105
BL-M12A591UY-XX	BL-M12B591UY-XX	AlGaInP	590	105
BL-M12A591UG-XX	BL-M12B591UG-XX	AlGaInP	574	135
BL-M12A591PG-XX	BL-M12B591PG-XX	InGaN	525	155
BL-M12A591B-XX	BL-M12B591B-XX	InGaN	470	75
BL-M12A591W-XX	BL-M12B591W-XX	InGaN	/	105

BL-M12X591 Series

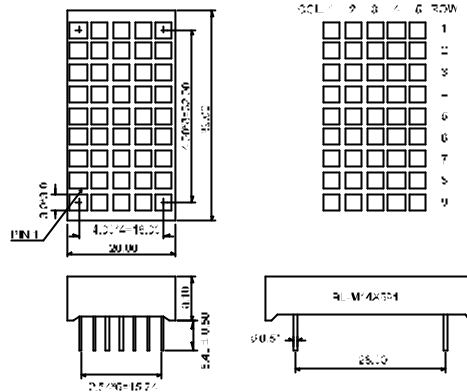

BL-M12A591

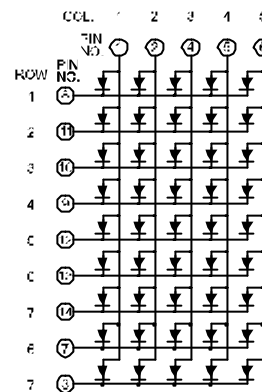

BL-M12B591

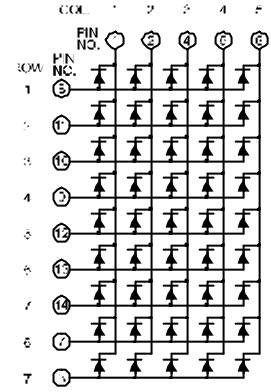

BL-M14A581S-XX	BL-M14B581S-XX	GaAlAs/GaAs,SH	660	105
BL-M14A581D-XX	BL-M14B581D-XX	GaAlAs/GaAs,DH	660	115
BL-M14A581UR-XX	BL-M14B581UR-XX	GaAlAs/GaAs,DDH	660	125
BL-M14A581E-XX	BL-M14B581E-XX	GaAsP/GaP	635	95
BL-M14A581Y-XX	BL-M14B581Y-XX	GaAsP/GaP	585	95
BL-M14A581G-XX	BL-M14B581G-XX	GaP/GaP	570	100
BL-M14A581UHR-XX	BL-M14B581UHR-XX	AlGaInP	645	125
BL-M14A581UE-XX	BL-M14B581UE-XX	AlGaInP	630	105
BL-M14A581YO-XX	BL-M14B581YO-XX	AlGaInP	619	105
BL-M14A581UY-XX	BL-M14B581UY-XX	AlGaInP	590	105
BL-M14A581UG-XX	BL-M14B581UG-XX	AlGaInP	574	135
BL-M14A581PG-XX	BL-M14B581PG-XX	InGaN	525	155
BL-M14A581B-XX	BL-M14B581B-XX	InGaN	470	75
BL-M14A581W-XX	BL-M14B581W-XX	InGaN	/	105

BL-M14X581 Series

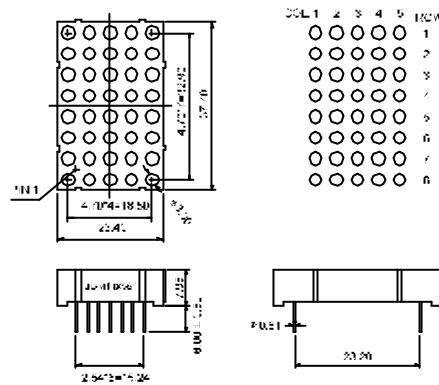

BL-M14A581

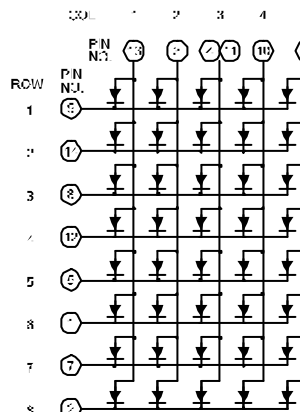

BL-M14B581

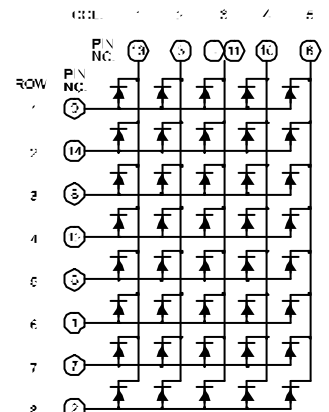

Dot Matrix LED Display

Part No		Chip		λ P (nm)	Typ.
CommonCathode	CommonAnode	Material			

Drawing

BL-M12A881S-XX	BL-M12B881S-XX	GaAlAs/GaAs,SH	660	200
BL-M12A881D-XX	BL-M12B881D-XX	GaAlAs/GaAs,DH	660	320
BL-M12A881UR-XX	BL-M12B881UR-XX	GaAlAs/GaAs,DDH	660	400
BL-M12A881E-XX	BL-M12B881E-XX	GaAsP/GaP	635	190
BL-M12A881Y-XX	BL-M12B881Y-XX	GaAsP/GaP	585	190
BL-M12A881G-XX	BL-M12B881G-XX	GaP/GaP	570	195
BL-M12A881UHR-XX	BL-M12B881UHR-XX	AlGaInP	645	400
BL-M12A881UE-XX	BL-M12B881UE-XX	AlGaInP	630	235
BL-M12A881YO-XX	BL-M12B881YO-XX	AlGaInP	619	235
BL-M12A881UY-XX	BL-M12B881UY-XX	AlGaInP	590	235
BL-M12A881UG-XX	BL-M12B881UG-XX	AlGaInP	574	250
BL-M12A881PG-XX	BL-M12B881PG-XX	InGaN	525	270
BL-M12A881B-XX	BL-M12B881B-XX	InGaN	470	180
BL-M12A881W-XX	BL-M12B881W-XX	InGaN	/	300

BL-M12X881 Series

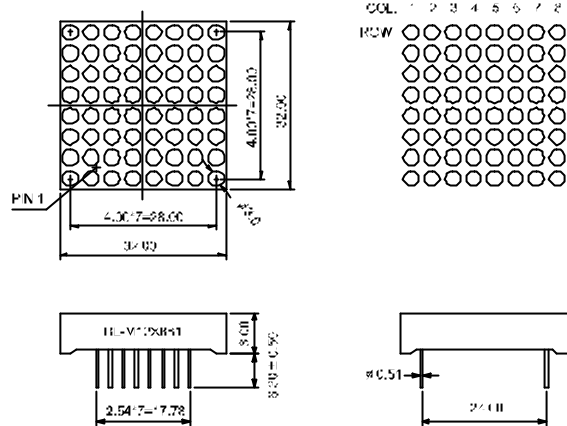

BL-M12A881

BL-M12B881

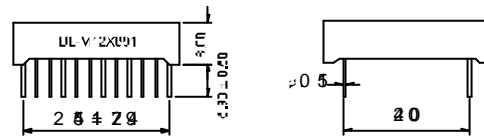
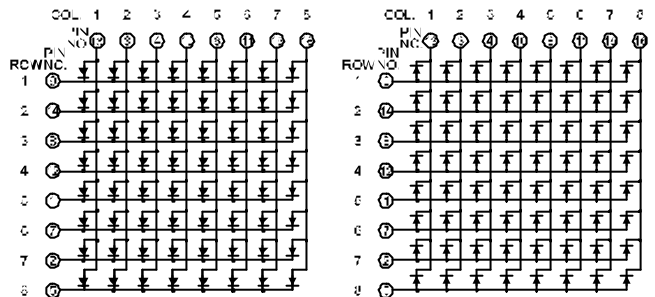

BL-M12A881EG

BL-M12B881EG

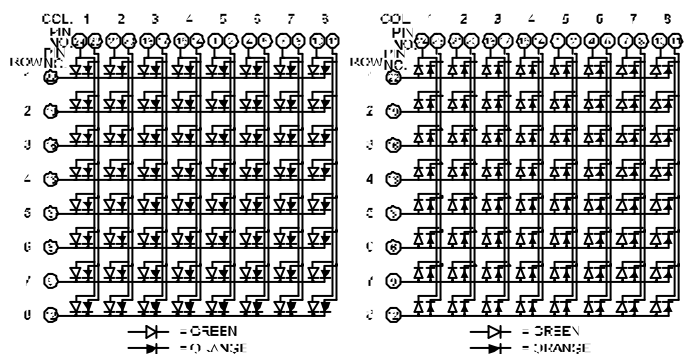

BL-M12A881SG-XX	BL-M12B881SG-XX	AlGaInP	660	200
BL-M12A881EG-XX	BL-M12B881EG-XX	GaP/GaP	570	195
BL-M12A881DUG-XX	BL-M12B881DUG-XX	GaAsP/GaP	635	190
BL-M12A881UEUG-XX	BL-M12B881UEUG-XX	GaP/GaP	570	195
		AlGaInP	660	320
		AlGaInP	574	250
		AlGaInP	630	235
		AlGaInP	574	250

Dot Matrix LED Display

Part No		Chip		λ P (nm)	Typ.	Drawing
CommonCathode	CommonAnode	Material				

BL-M12A882S-XX	BL-M12B882S-XX	GaAlAs/GaAs,SH	660	200
BL-M12A882D-XX	BL-M12B882D-XX	GaAlAs/GaAs,DH	660	320
BL-M12A882UR-XX	BL-M12B882UR-XX	GaAlAs/GaAs,DDH	660	400
BL-M12A882E-XX	BL-M12B882E-XX	GaAsP/GaP	635	190
BL-M12A882Y-XX	BL-M12B882Y-XX	GaAsP/GaP	585	190
BL-M12A882G-XX	BL-M12B882G-XX	GaP/GaP	570	195
BL-M12A882UHR-XX	BL-M12B882UHR-XX	AlGaInP	645	400
BL-M12A882UE-XX	BL-M12B882UE-XX	AlGaInP	630	235
BL-M12A882YO-XX	BL-M12B882YO-XX	AlGaInP	619	235
BL-M12A882UY-XX	BL-M12B882UY-XX	AlGaInP	590	235
BL-M12A882UG-XX	BL-M12B882UG-XX	AlGaInP	574	250
BL-M12A882PG-XX	BL-M12B882PG-XX	InGaN	525	270
BL-M12A882B-XX	BL-M12B882B-XX	InGaN	470	180
BL-M12A882W-XX	BL-M12B882W-XX	InGaN	/	300

BL-M12X882 Series

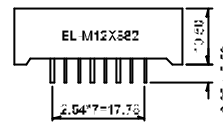
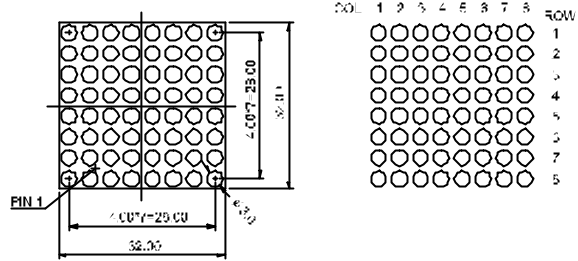

BL-M12A882

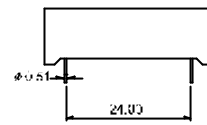

BL-M12B882

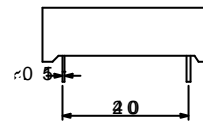
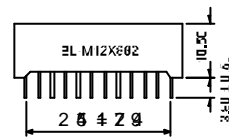
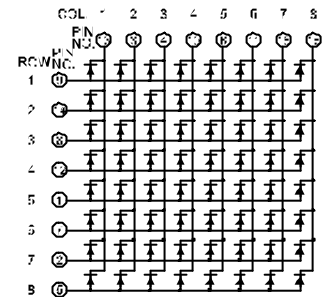
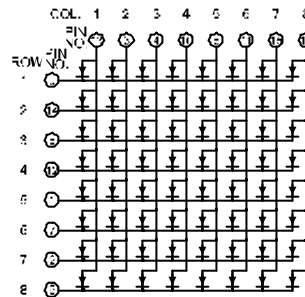

BL-M12A882EG

BL-M12B882EG

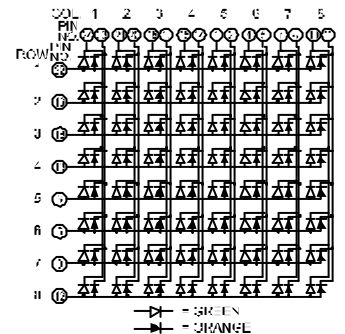
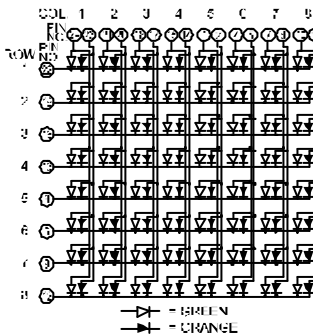

BL-M12A882SG-XX	BL-M12B882SG-XX	AlGaInP	660	200
		GaP/GaP	570	195
BL-M12A882EG-XX	BL-M12B882EG-XX	GaAsP/GaP	635	190
		GaP/GaP	570	195
BL-M12A882DUG-XX	BL-M12B882DUG-XX	AlGaInP	660	320
		AlGaInP	574	250
BL-M12A882UEUG-XX	BL-M12B882UEUG-XX	AlGaInP	630	235
		AlGaInP	574	250

Dot Matrix LED Display

Part No		Chip		Iv(mcd)	Typ.
CommonCathode	CommonAnode	Material	λ P (nm)		
BL-M12A883S-XX	BL-M12B883S-XX	GaAlAs/GaAs,SH	660	200	
BL-M12A883D-XX	BL-M12B883D-XX	GaAlAs/GaAs,DH	660	320	
BL-M12A883UR-XX	BL-M12B883UR-XX	GaAlAs/GaAs,DDH	660	400	
BL-M12A883E-XX	BL-M12B883E-XX	GaAsP/GaP	635	190	
BL-M12A883Y-XX	BL-M12B883Y-XX	GaAsP/GaP	585	190	
BL-M12A883G-XX	BL-M12B883G-XX	GaP/GaP	570	195	
BL-M12A883UHR-XX	BL-M12B883UHR-XX	AlGaInP	645	400	
BL-M12A883UE-XX	BL-M12B883UE-XX	AlGaInP	630	235	
BL-M12A883YO-XX	BL-M12B883YO-XX	AlGaInP	619	235	
BL-M12A883UY-XX	BL-M12B883UY-XX	AlGaInP	590	235	
BL-M12A883UG-XX	BL-M12B883UG-XX	AlGaInP	574	250	
BL-M12A883PG-XX	BL-M12B883PG-XX	InGaN	525	270	
BL-M12A883B-XX	BL-M12B883B-XX	InGaN	470	180	
BL-M12A883W-XX	BL-M12B883W-XX	InGaN	/	300	

BL-M12A883SG-XX	BL-M12B883SG-XX	AlGaInP	660	200
		GaP/GaP	570	195
BL-M12A883EG-XX	BL-M12B883EG-XX	GaAsP/GaP	635	190
		GaP/GaP	570	195
BL-M12A883DUG-XX	BL-M12B883DUG-XX	AlGaInP	660	320
		AlGaInP	574	250
BL-M12A883UEUG-XX	BL-M12B883UEUG-XX	AlGaInP	630	235
		AlGaInP	574	250

Drawing

BL-M12X883Series

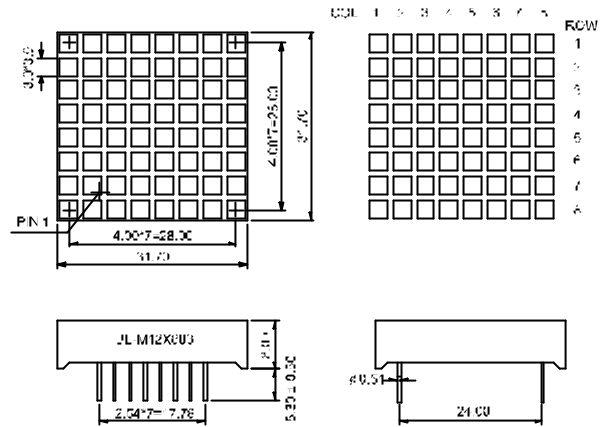

BL-M12A883

BL-M12B883

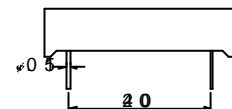
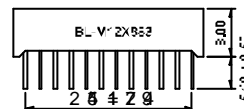
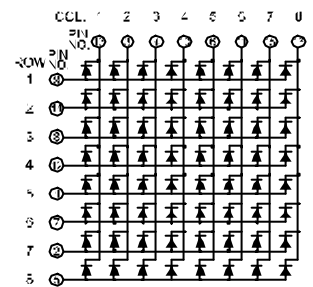
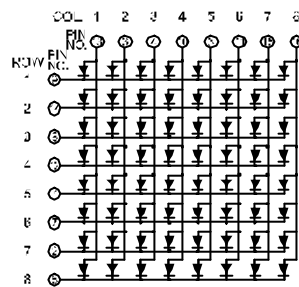

BL-M12A883EG

BL-M12B883EG

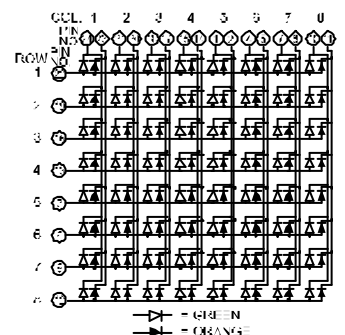
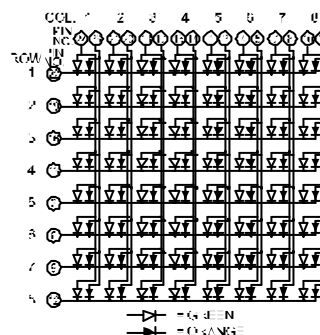

Dot Matrix LED Display

Part No		Chip		λ P (nm)	Typ.	Drawing
CommonCathode	CommonAnode	Material				

BL-M15A881S-XX	BL-M15B881S-XX	GaAlAs/GaAs,SH	660	250
BL-M15A881D-XX	BL-M15B881D-XX	GaAlAs/GaAs,DH	660	320
BL-M15A881UR-XX	BL-M15B881UR-XX	GaAlAs/GaAs,DDH	660	400
BL-M15A881E-XX	BL-M15B881E-XX	GaAsP/GaP	635	190
BL-M15A881Y-XX	BL-M15B881Y-XX	GaAsP/GaP	585	190
BL-M15A881G-XX	BL-M15B881G-XX	GaP/GaP	570	195
BL-M15A881UHR-XX	BL-M15B881UHR-XX	AlGaInP	645	400
BL-M15A881UE-XX	BL-M15B881UE-XX	AlGaInP	630	235
BL-M15A881YO-XX	BL-M15B881YO-XX	AlGaInP	619	235
BL-M15A881UY-XX	BL-M15B881UY-XX	AlGaInP	590	235
BL-M15A881UG-XX	BL-M15B881UG-XX	AlGaInP	574	250
BL-M15A881PG-XX	BL-M15B881PG-XX	InGaN	525	270
BL-M15A881B-XX	BL-M15B881B-XX	InGaN	470	180
BL-M15A881W-XX	BL-M15B881W-XX	InGaN	/	235

BL-M15X881 Series

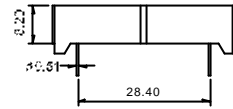
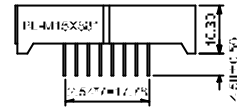
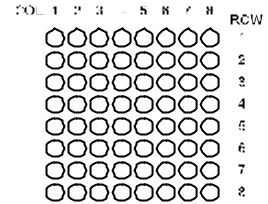
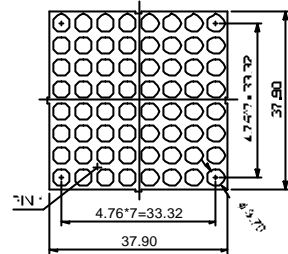

BL-M15A881

BL-M15B881

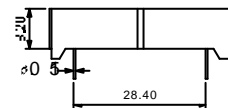
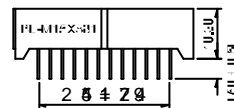
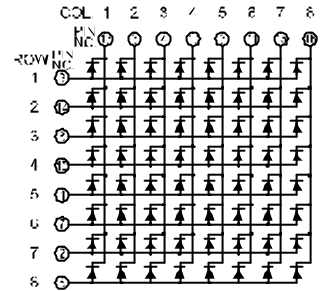
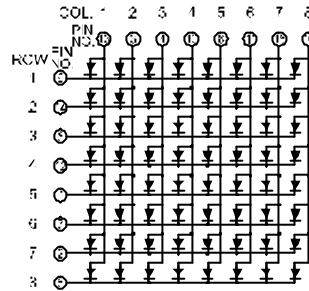

BL-M15A881EG

BL-M15B881EG

BL-M15A881SG-XX	BL-M15B881SG-XX	AlGaInP	660	250
		GaP/GaP	570	195
BL-M15A881EG-XX	BL-M15B881EG-XX	GaAsP/GaP	635	190
		GaP/GaP	570	195
BL-M15A881DUG-XX	BL-M15B881DUG-XX	AlGaInP	660	320
		AlGaInP	574	250
BL-M15A881UEUG-XX	BL-M15B881UEUG-XX	AlGaInP	630	235
		AlGaInP	574	250

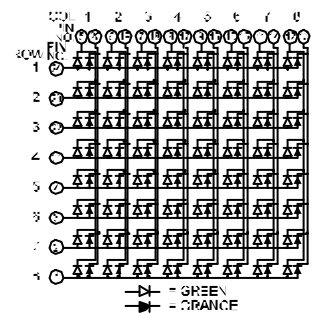
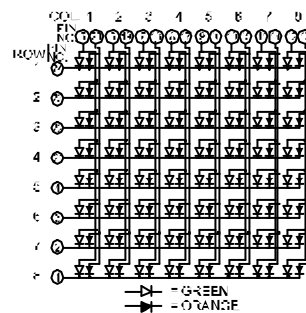

Dot Matrix LED Display

Part No		Chip		λ P (nm)	Typ.	Drawing
CommonCathode	CommonAnode	Material				

BL-M15A882S-XX	BL-M15B882S-XX	GaAlAs/GaAs,SH	660	250
BL-M15A882D-XX	BL-M15B882D-XX	GaAlAs/GaAs,DH	660	320
BL-M15A882UR-XX	BL-M15B882UR-XX	GaAlAs/GaAs,DDH	660	400
BL-M15A882E-XX	BL-M15B882E-XX	GaAsP/GaP	635	190
BL-M15A882Y-XX	BL-M15B882Y-XX	GaAsP/GaP	585	190
BL-M15A882G-XX	BL-M15B882G-XX	GaP/GaP	570	195
BL-M15A882UHR-XX	BL-M15B882UHR-XX	AlGaInP	645	400
BL-M15A882UE-XX	BL-M15B882UE-XX	AlGaInP	630	235
BL-M15A882YO-XX	BL-M15B882YO-XX	AlGaInP	619	235
BL-M15A882UY-XX	BL-M15B882UY-XX	AlGaInP	590	235
BL-M15A882UG-XX	BL-M15B882UG-XX	AlGaInP	574	250
BL-M15A882PG-XX	BL-M15B882PG-XX	InGaN	525	270
BL-M15A882B-XX	BL-M15B882B-XX	InGaN	470	180
BL-M15A882W-XX	BL-M15B882W-XX	InGaN	/	235

BL-M15A882SG-XX	BL-M15B882SG-XX	AlGaInP	660	250
		GaP/GaP	570	195
BL-M15A882EG-XX	BL-M15B882EG-XX	GaAsP/GaP	635	190
		GaP/GaP	570	195
BL-M15A882DUG-XX	BL-M15B882DUG-XX	AlGaInP	660	320
		AlGaInP	574	250
BL-M15A882UEUG-XX	BL-M15B882UEUG-XX	AlGaInP	630	235
		AlGaInP	574	250

BL-M15X882 Series

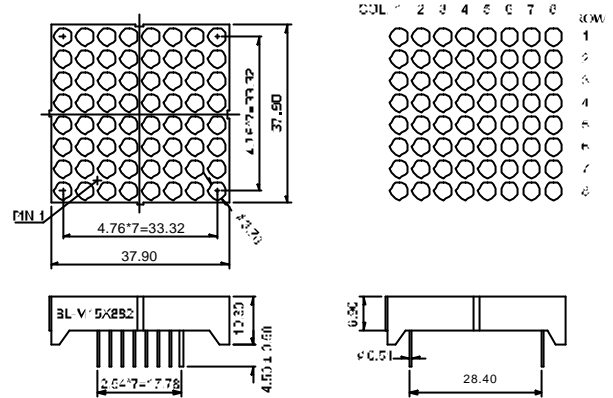

BL-M15A882

BL-M15B882

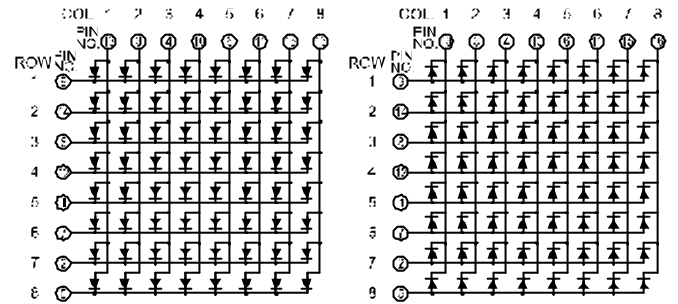

BL-M15A882EG

BL-M15B882EG

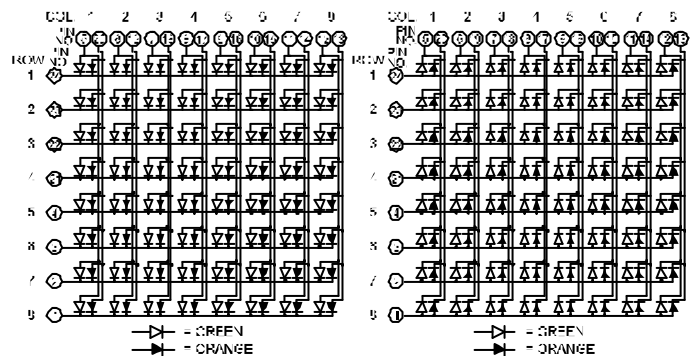

Dot Matrix LED Display

Part No		Chip		λ P (nm)		Typ.
CommonCathode	CommonAnode	Material				
BL-M19A881S-XX	BL-M19B881S-XX	GaAlAs/GaAs,SH	■	660	270	
BL-M19A881D-XX	BL-M19B881D-XX	GaAlAs/GaAs,DH	■	660	310	
BL-M19A881UR-XX	BL-M19B881UR-XX	GaAlAs/GaAs,DDH	■	660	450	
BL-M19A881E-XX	BL-M19B881E-XX	GaAsP/GaP	■	635	220	
BL-M19A881Y-XX	BL-M19B881Y-XX	GaAsP/GaP	■	585	220	
BL-M19A881G-XX	BL-M19B881G-XX	GaP/GaP	■	570	240	
BL-M19A881UHR-XX	BL-M19B881UHR-XX	AlGaInP	■	645	450	
BL-M19A881UE-XX	BL-M19B881UE-XX	AlGaInP	■	630	255	
BL-M19A881YO-XX	BL-M19B881YO-XX	AlGaInP	■	619	255	
BL-M19A881UY-XX	BL-M19B881UY-XX	AlGaInP	■	590	255	
BL-M19A881UG-XX	BL-M19B881UG-XX	AlGaInP	■	574	380	
BL-M19A881PG-XX	BL-M19B881PG-XX	InGaN	■	525	400	
BL-M19A881B-XX	BL-M19B881B-XX	InGaN	■	470	270	
BL-M19A881W-XX	BL-M19B881W-XX	InGaN	□	/	350	

BL-M19A881SG-XX	BL-M19B881SG-XX	AlGaInP	■	660	270
		GaP/GaP	■	570	240
BL-M19A881EG-XX	BL-M19B881EG-XX	GaAsP/GaP	■	635	220
		GaP/GaP	■	570	240
BL-M19A881DUG-XX	BL-M19B881DUG-XX	AlGaInP	■	660	310
		AlGaInP	■	574	380
BL-M19A881UEUG-XX	BL-M19B881UEUG-XX	AlGaInP	■	630	255
		AlGaInP	■	574	380

BL-M19C881SG-XX	BL-M19D881SG-XX	AlGaInP	■	660	270
		GaP/GaP	■	570	240
BL-M19C881EG-XX	BL-M19D881EG-XX	GaAsP/GaP	■	635	220
		GaP/GaP	■	570	240
BL-M19C881DUG-XX	BL-M19D881DUG-XX	AlGaInP	■	660	310
		AlGaInP	■	574	380
BL-M19C881UEUG-XX	BL-M19D881UEUG-XX	AlGaInP	■	630	255
		AlGaInP	■	574	380

Drawing

BL-M19X881 Series

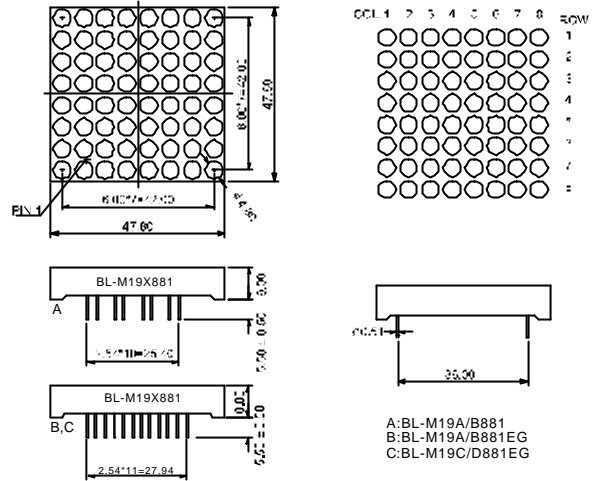

BL-M19A881

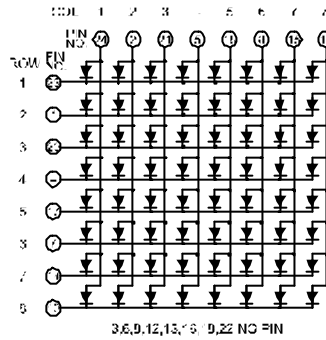

BL-M19B881

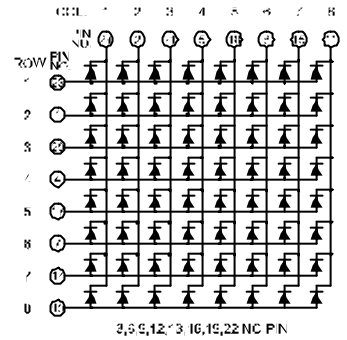

BL-M19A881EG

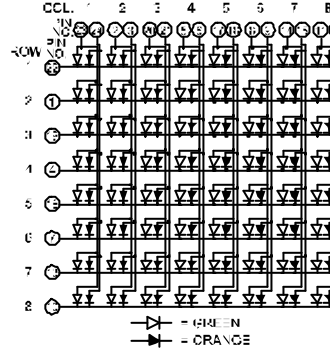

BL-M19B881EG

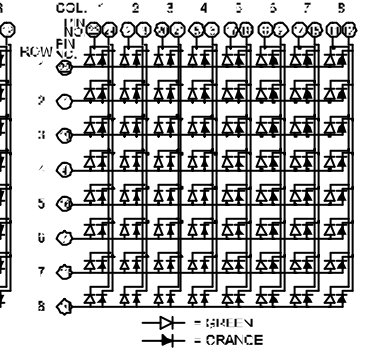

BL-M19C881EG

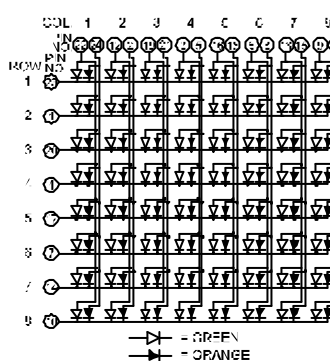

BL-M19D881EG

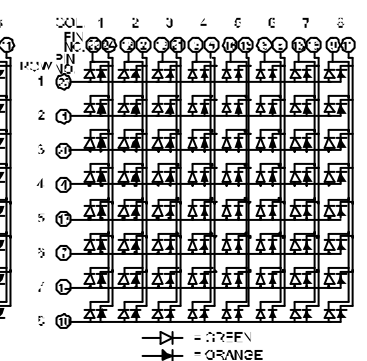

Dot Matrix LED Display

Part No		Chip		Iv(mcd)
CommonCathode	CommonAnode	Material	λ P (nm)	Typ.

Drawing

BL-M19C881S-XX	BL-M19D881S-XX	GaAlAs/GaAs,SH	660	270
BL-M19C881D-XX	BL-M19D881D-XX	GaAlAs/GaAs,DH	660	310
BL-M19C881UR-XX	BL-M19D881UR-XX	GaAlAs/GaAs,DDH	660	450
BL-M19C881E-XX	BL-M19D881E-XX	GaAsP/GaP	635	220
BL-M19C881Y-XX	BL-M19D881Y-XX	GaAsP/GaP	585	220
BL-M19C881G-XX	BL-M19D881G-XX	GaP/GaP	570	240
BL-M19C881UHR-XX	BL-M19D881UHR-XX	AlGaInP	645	450
BL-M19C881UE-XX	BL-M19D881UE-XX	AlGaInP	630	255
BL-M19C881YO-XX	BL-M19D881YO-XX	AlGaInP	619	255
BL-M19C881UY-XX	BL-M19D881UY-XX	AlGaInP	590	255
BL-M19C881UG-XX	BL-M19D881UG-XX	AlGaInP	574	380
BL-M19C881PG-XX	BL-M19D881PG-XX	InGaN	525	400
BL-M19C881B-XX	BL-M19D881B-XX	InGaN	470	270
BL-M19C881W-XX	BL-M19D881W-XX	InGaN	/	350

BL-M19E881SG-XX	BL-M19F881SG-XX	AlGaInP	660	270
		GaP/GaP	570	240
BL-M19E881EG-XX	BL-M19F881EG-XX	GaAsP/GaP	635	220
		GaP/GaP	570	240
BL-M19E881DUG-XX	BL-M19F881DUG-XX	AlGaInP	660	310
		AlGaInP	574	380
BL-M19E881UEUG-XX	BL-M19F881UEUG-XX	AlGaInP	630	255
		AlGaInP	574	380

BL-M19A881RGB-XX	BL-M19B881RGB-XX	GaAlAs/GaAs,DH	660	270
		GaP/GaP	570	240
		InGaN	470	150
BL-M19A881DUGUB-XX	BL-M19B881DUGUB-XX	GaAlAs/GaAs,DDH	660	310
		AlGaInP	574	380
		InGaN	470	270

BL-M19X881 Series

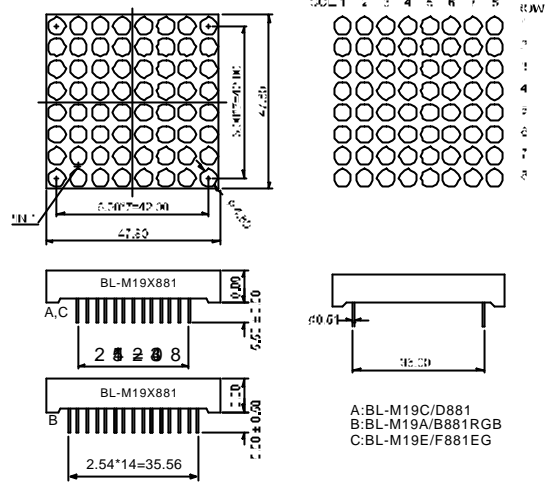

BL-M19C881

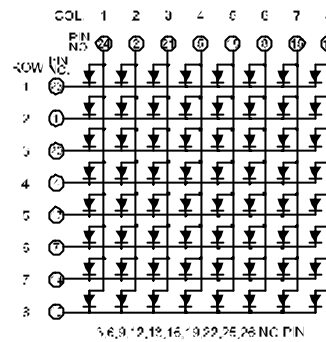

BL-M19D881

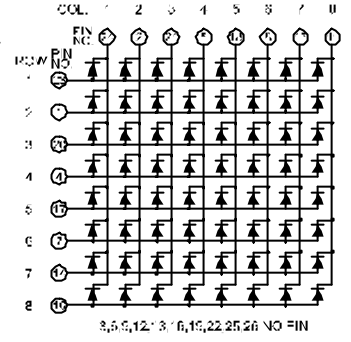

BL-M19E881EG

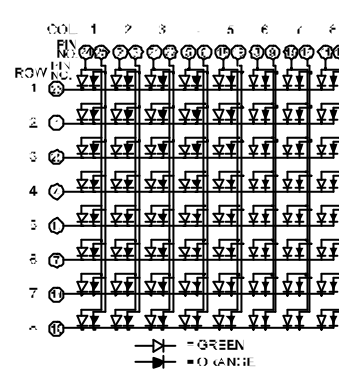

BL-M19F881EG

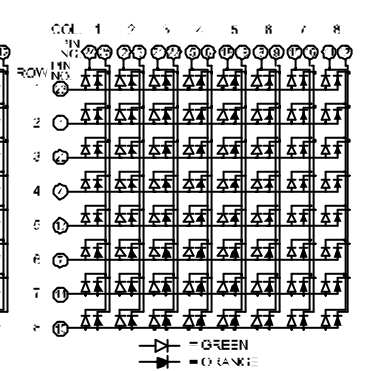

BL-M19B881RGB (BL-M19A881RGB C.C.)

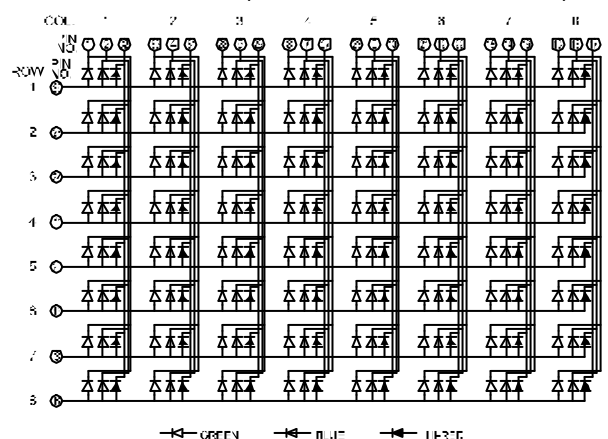

Dot Matrix LED Display

Part No		Chip		lv(mcd)
CommonCathode	CommonAnode	Material	λP (nm)	Typ.

Drawing

BL-M20A571S-XX	BL-M20B571S-XX	GaAlAs/GaAs,SH	660	120
BL-M20A571D-XX	BL-M20B571D-XX	GaAlAs/GaAs,DH	660	140
BL-M20A571UR-XX	BL-M20B571UR-XX	GaAlAs/GaAs,DDH	660	160
BL-M20A571E-XX	BL-M20B571E-XX	GaAsP/GaP	635	90
BL-M20A571Y-XX	BL-M20B571Y-XX	GaAsP/GaP	585	90
BL-M20A571G-XX	BL-M20B571G-XX	GaP/GaP	570	95
BL-M20A571UHR-XX	BL-M20B571UHR-XX	AlGaInP	645	160
BL-M20A571UE-XX	BL-M20B571UE-XX	AlGaInP	630	130
BL-M20A571YO-XX	BL-M20B571YO-XX	AlGaInP	619	130
BL-M20A571UY-XX	BL-M20B571UY-XX	AlGaInP	590	130
BL-M20A571UG-XX	BL-M20B571UG-XX	AlGaInP	574	170
BL-M20A571PG-XX	BL-M20B571PG-XX	InGaN	525	200
BL-M20A571B-XX	BL-M20B571B-XX	InGaN	470	90
BL-M20A571W-XX	BL-M20B571W-XX	InGaN	/	130

BL-M20A571SG-XX	BL-M20B571SG-XX	AlGaInP	660	120
		GaP/GaP	570	95
BL-M20A571EG-XX	BL-M20B571EG-XX	GaAsP/GaP	635	90
		GaP/GaP	570	95
BL-M20A571DUG-XX	BL-M20B571DUG-XX	AlGaInP	660	140
		AlGaInP	574	170
BL-M20A571UEUG-XX	BL-M20B571UEUG-XX	AlGaInP	630	130
		AlGaInP	574	170

BL-M20A571RGB-XX	BL-M20B571RGB-XX	GaAlAs/GaAs,DH	660	120
		GaP/GaP	570	95
		InGaN	470	65
BL-M20A571DUGUB-XX	BL-M20B571DUGUB-XX	GaAlAs/GaAs,DDH	660	140
		AlGaInP	574	130
		InGaN	470	90

BL-M20X571 Series

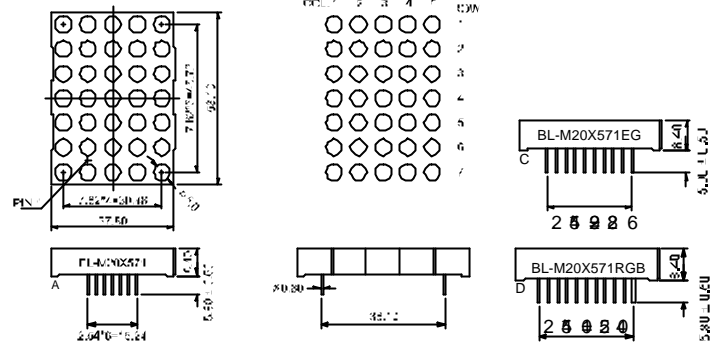

BL-M20A571

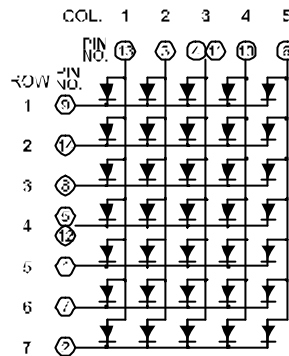

BL-M20A571EG

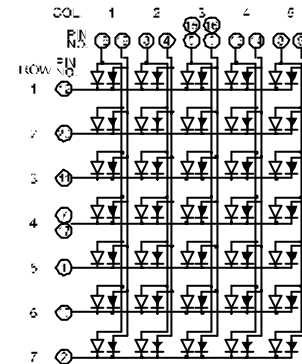

BL-M20A571RGB

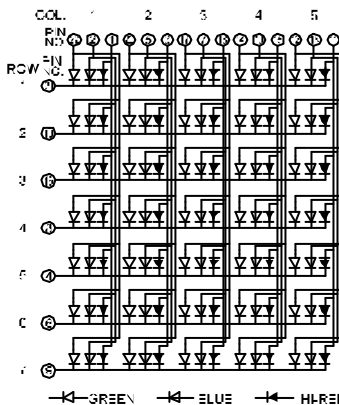

← GREEN ← BLUE ← HIRED

BL-M20B571

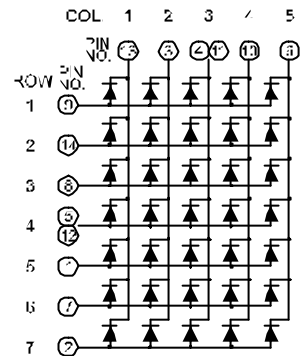

BL-M20B571EG

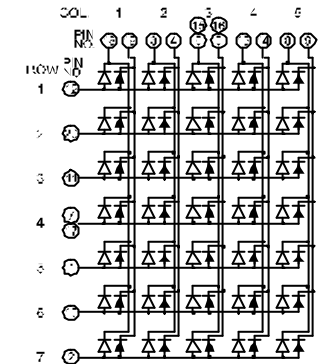

BL-M20B571RGB

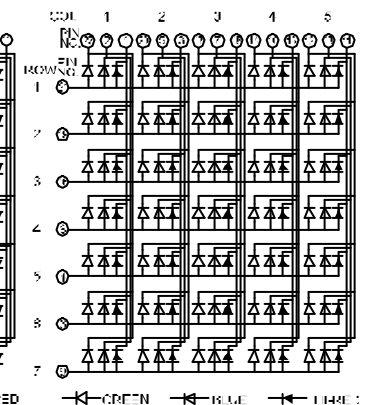

← GREEN ← BLUE ← HIRED

Dot Matrix LED Display

Part No		Chip		λ P (nm)	Typ.
CommonCathode	CommonAnode	Material			
BL-M23A581S-XX	BL-M23B581S-XX	GaAlAs/GaAs,SH	660	280	
BL-M23A581D-XX	BL-M23B581D-XX	GaAlAs/GaAs,DH	660	320	
BL-M23A581UR-XX	BL-M23B581UR-XX	GaAlAs/GaAs,DDH	660	446	
BL-M23A581E-XX	BL-M23B581E-XX	GaAsP/GaP	635	220	
BL-M23A581Y-XX	BL-M23B581Y-XX	GaAsP/GaP	585	220	
BL-M23A581G-XX	BL-M23B581G-XX	GaP/GaP	570	240	
BL-M23A581UHR-XX	BL-M23B581UHR-XX	AlGaInP	645	446	
BL-M23A581UE-XX	BL-M23B581UE-XX	AlGaInP	630	400	
BL-M23A581YO-XX	BL-M23B581YO-XX	AlGaInP	619	400	
BL-M23A581UY-XX	BL-M23B581UY-XX	AlGaInP	590	400	
BL-M23A581UG-XX	BL-M23B581UG-XX	AlGaInP	574	470	
BL-M23A581PG-XX	BL-M23B581PG-XX	InGaN	525	500	
BL-M23A581B-XX	BL-M23B581B-XX	InGaN	470	250	
BL-M23A581W-XX	BL-M23B581W-XX	InGaN	/	400	

Drawing

BL-M23X581 Series

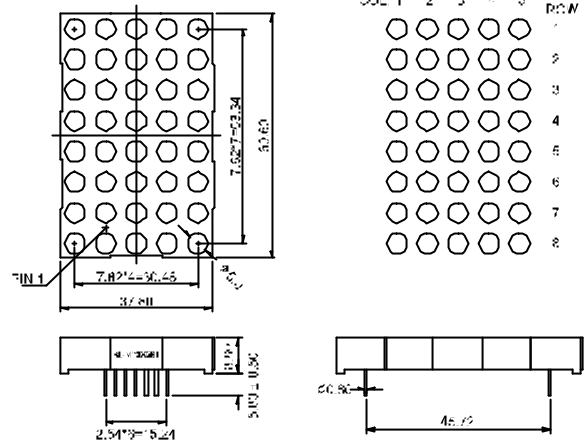

BL-M23A581

BL-M23B581

BL-M23C581S-XX	BL-M23D581S-XX	GaAlAs/GaAs,SH	660	280
BL-M23C581D-XX	BL-M23D581D-XX	GaAlAs/GaAs,DH	660	320
BL-M23C581UR-XX	BL-M23D581UR-XX	GaAlAs/GaAs,DDH	660	446
BL-M23C581E-XX	BL-M23D581E-XX	GaAsP/GaP	635	220
BL-M23C581Y-XX	BL-M23D581Y-XX	GaAsP/GaP	585	220
BL-M23C581G-XX	BL-M23D581G-XX	GaP/GaP	570	240
BL-M23C581UHR-XX	BL-M23D581UHR-XX	AlGaInP	645	446
BL-M23C581UE-XX	BL-M23D581UE-XX	AlGaInP	630	400
BL-M23C581YO-XX	BL-M23D581YO-XX	AlGaInP	619	400
BL-M23C581UY-XX	BL-M23D581UY-XX	AlGaInP	590	400
BL-M23C581UG-XX	BL-M23D581UG-XX	AlGaInP	574	470
BL-M23C581PG-XX	BL-M23D581PG-XX	InGaN	525	500
BL-M23C581B-XX	BL-M23D581B-XX	InGaN	470	250
BL-M23C581W-XX	BL-M23D581W-XX	InGaN	/	400

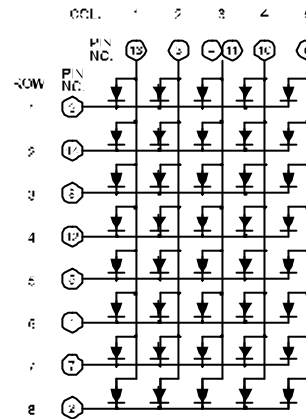

BL-M23C581

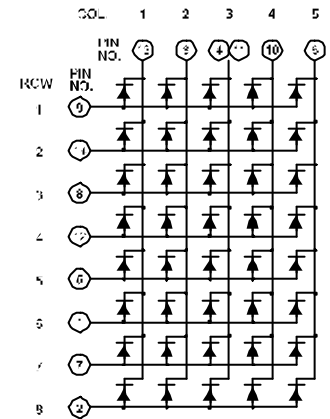

BL-M23D581

Dot Matrix LED Display

Part No		Chip		Iv(mcd)	Drawing
CommonCathode	CommonAnode	Material	λP (nm)	Typ.	

BL-M23A581SG-XX	BL-M23B581SG-XX	AlGaInP	660	280
		GaP/GaP	570	240
BL-M23A581EG-XX	BL-M23B581EG-XX	GaAsP/GaP	635	220
		GaP/GaP	570	240
BL-M23A581DUG-XX	BL-M23B581DUG-XX	AlGaInP	660	320
		AlGaInP	574	470
BL-M23A581UEUG-XX	BL-M23B581UEUG-XX	AlGaInP	630	400
		AlGaInP	574	470

BL-M23C581SG-XX	BL-M23D581SG-XX	AlGaInP	660	280
		GaP/GaP	570	240
BL-M23C581EG-XX	BL-M23D581EG-XX	GaAsP/GaP	635	220
		GaP/GaP	570	240
BL-M23C581DUG-XX	BL-M23D581DUG-XX	AlGaInP	660	320
		AlGaInP	574	470
BL-M23C581UEUG-XX	BL-M23D581UEUG-XX	AlGaInP	630	400
		AlGaInP	574	470

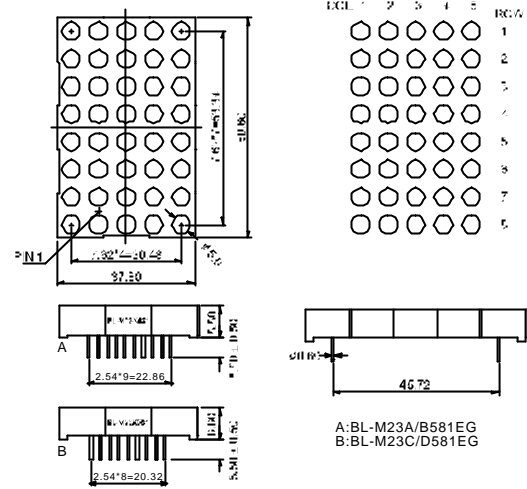

BL-M23A581EG

BL-M23B581EG

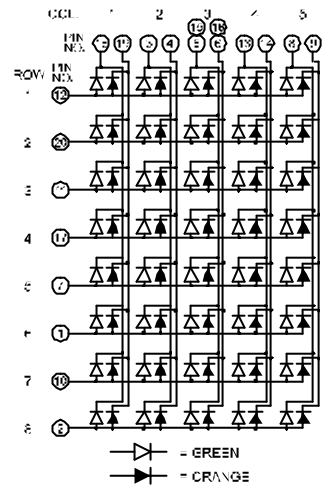
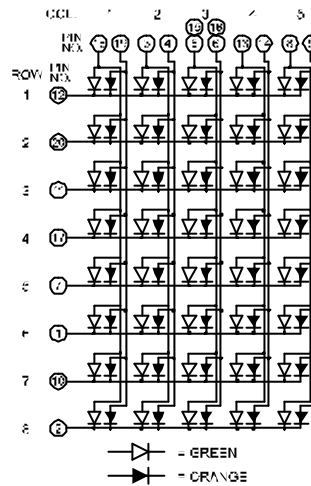

BL-M23C581EG

BL-M23D581EG

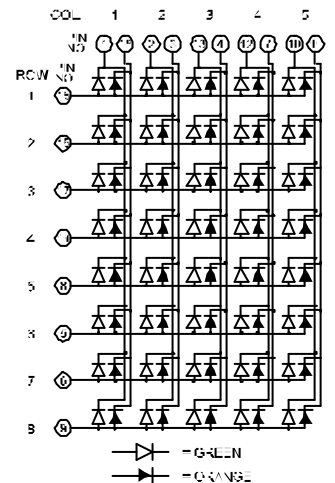
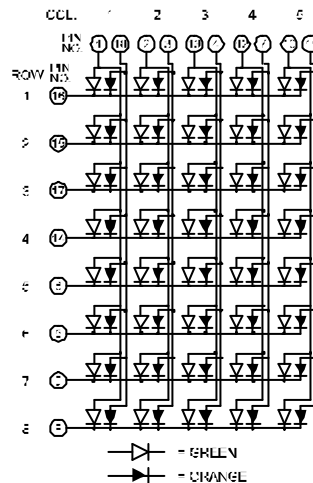

Dot Matrix LED Display

Part No		Chip		Iv(mcd)	Typ.
CommonCathode	CommonAnode	Material	λ P (nm)		
BL-M20A881S-XX	BL-M20B881S-XX	GaAlAs/GaAs,SH	660	270	
BL-M20A881D-XX	BL-M20B881D-XX	GaAlAs/GaAs,DH	660	310	
BL-M20A881UR-XX	BL-M20B881UR-XX	GaAlAs/GaAs,DDH	660	450	
BL-M20A881E-XX	BL-M20B881E-XX	GaAsP/GaP	635	220	
BL-M20A881Y-XX	BL-M20B881Y-XX	GaAsP/GaP	585	220	
BL-M20A881G-XX	BL-M20B881G-XX	GaP/GaP	570	240	
BL-M20A881UHR-XX	BL-M20B881UHR-XX	AlGaInP	645	450	
BL-M20A881UE-XX	BL-M20B881UE-XX	AlGaInP	630	255	
BL-M20A881YO-XX	BL-M20B881YO-XX	AlGaInP	619	255	
BL-M20A881UY-XX	BL-M20B881UY-XX	AlGaInP	590	255	
BL-M20A881UG-XX	BL-M20B881UG-XX	AlGaInP	574	380	
BL-M20A881PG-XX	BL-M20B881PG-XX	InGaN	525	400	
BL-M20A881B-XX	BL-M20B881B-XX	InGaN	470	270	
BL-M20A881W-XX	BL-M20B881W-XX	InGaN	/	350	

BL-M20A881SG-XX	BL-M20B881SG-XX	AlGaInP	660	270
		GaP/GaP	570	240
BL-M20A881EG-XX	BL-M20B881EG-XX	GaAsP/GaP	635	220
		GaP/GaP	570	240
BL-M20A881DUG-XX	BL-M20B881DUG-XX	AlGaInP	660	310
		AlGaInP	574	380
BL-M20A881UEUG-XX	BL-M20B881UEUG-XX	AlGaInP	630	255
		AlGaInP	574	380

Drawing

BL-M20X881 Series

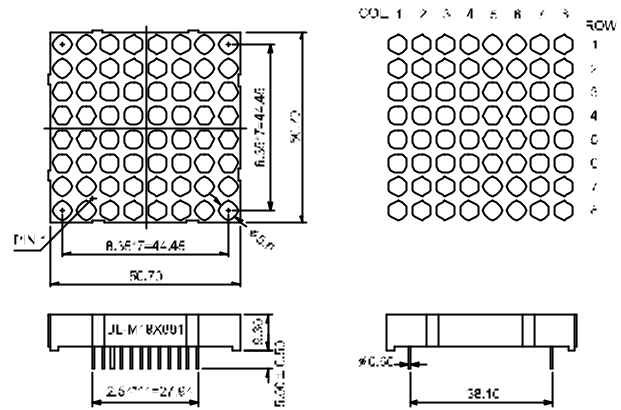

BL-M20A881

BL-M20B881

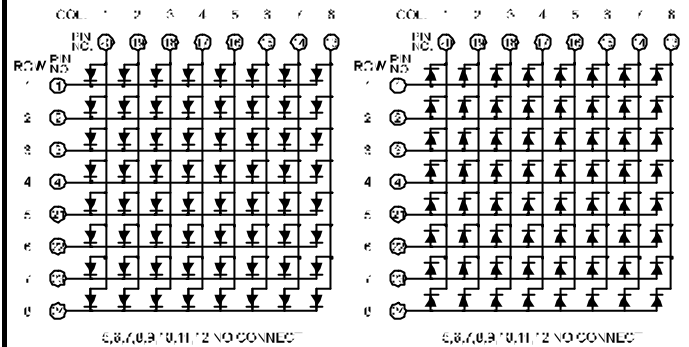

BL-M20A881EG

BL-M20B881EG

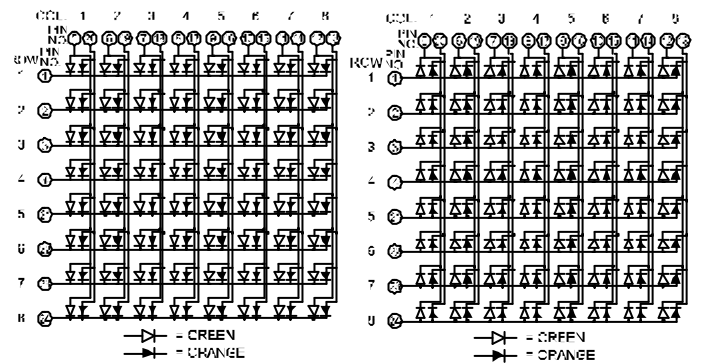

Dot Matrix LED Display

Part No		Chip		Iv(mcd)	Typ.	Drawing
CommonCathode	CommonAnode	Material	λ P (nm)			

BL-M23A881S-XX	BL-M23B881S-XX	GaAlAs/GaAs,SH	660	280
BL-M23A881D-XX	BL-M23B881D-XX	GaAlAs/GaAs,DH	660	310
BL-M23A881UR-XX	BL-M23B881UR-XX	GaAlAs/GaAs,DDH	660	450
BL-M23A881E-XX	BL-M23B881E-XX	GaAsP/GaP	635	220
BL-M23A881Y-XX	BL-M23B881Y-XX	GaAsP/GaP	585	220
BL-M23A881G-XX	BL-M23B881G-XX	GaP/GaP	570	250
BL-M23A881UHR-XX	BL-M23B881UHR-XX	AlGaInP	645	450
BL-M23A881UE-XX	BL-M23B881UE-XX	AlGaInP	630	255
BL-M23A881YO-XX	BL-M23B881YO-XX	AlGaInP	619	255
BL-M23A881UY-XX	BL-M23B881UY-XX	AlGaInP	590	255
BL-M23A881UG-XX	BL-M23B881UG-XX	AlGaInP	574	380
BL-M23A881PG-XX	BL-M23B881PG-XX	InGaN	525	560
BL-M23A881B-XX	BL-M23B881B-XX	InGaN	470	270
BL-M23A881W-XX	BL-M23B881W-XX	InGaN	/	350

BL-M23C881S-XX	BL-M23D881S-XX	GaAlAs/GaAs,SH	660	280
BL-M23C881D-XX	BL-M23D881D-XX	GaAlAs/GaAs,DH	660	310
BL-M23C881UR-XX	BL-M23D881UR-XX	GaAlAs/GaAs,DDH	660	450
BL-M23C881E-XX	BL-M23D881E-XX	GaAsP/GaP	635	220
BL-M23C881Y-XX	BL-M23D881Y-XX	GaAsP/GaP	585	220
BL-M23C881G-XX	BL-M23D881G-XX	GaP/GaP	570	250
BL-M23C881UHR-XX	BL-M23D881UHR-XX	AlGaInP	645	450
BL-M23C881UE-XX	BL-M23D881UE-XX	AlGaInP	630	255
BL-M23C881YO-XX	BL-M23D881YO-XX	AlGaInP	619	255
BL-M23C881UY-XX	BL-M23D881UY-XX	AlGaInP	590	255
BL-M23C881UG-XX	BL-M23D881UG-XX	AlGaInP	574	380
BL-M23C881PG-XX	BL-M23D881PG-XX	InGaN	525	560
BL-M23C881B-XX	BL-M23D881B-XX	InGaN	470	270
BL-M23C881W-XX	BL-M23D881W-XX	InGaN	/	350

BL-M23X881 Series

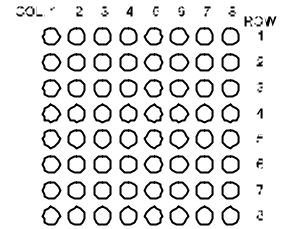
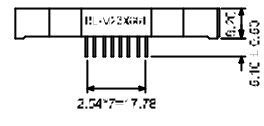
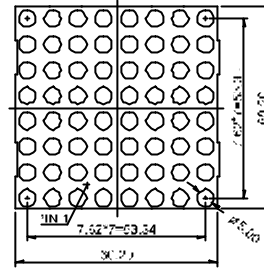

BL-M23A881

BL-M23B881

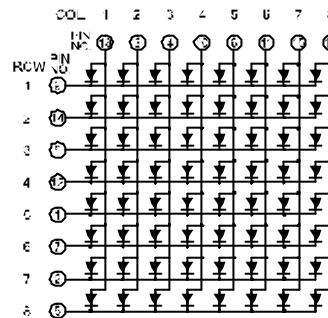

BL-M23C881

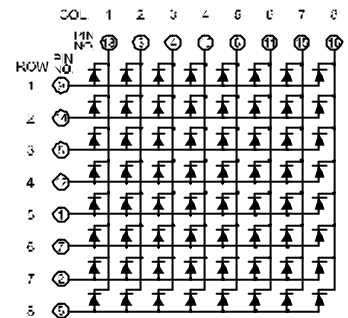

BL-M23D881

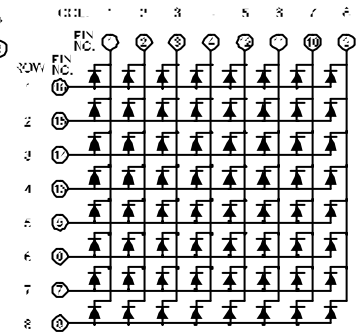
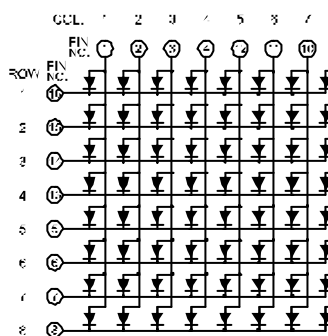

Dot Matrix LED Display

Part No		Chip		Iv(mcd)	Typ.	Drawing
CommonCathode	CommonAnode	Material	λP (nm)			

BL-M23A881SG-XX	BL-M23B881SG-XX	AlGaInP	660	280
		GaP/GaP	570	250
BL-M23A881EG-XX	BL-M23B881EG-XX	GaAsP/GaP	635	255
		GaP/GaP	570	250
BL-M23A881DUG-XX	BL-M23B881DUG-XX	AlGaInP	660	310
		AlGaInP	574	380
BL-M23A881UEUG-XX	BL-M23B881UEUG-XX	AlGaInP	630	255
		AlGaInP	574	380

BL-M23C881SG-XX	BL-M23D881SG-XX	AlGaInP	660	280
		GaP/GaP	570	250
BL-M23C881EG-XX	BL-M23D881EG-XX	GaAsP/GaP	635	255
		GaP/GaP	570	250
BL-M23C881DUG-XX	BL-M23D881DUG-XX	AlGaInP	660	310
		AlGaInP	574	380
BL-M23C881UEUG-XX	BL-M23D881UEUG-XX	AlGaInP	630	255
		AlGaInP	574	380

BL-M23A881RGB-XX	BL-M23B881RGB-XX	GaAlAs/GaAs,DH	660	280
		GaP/GaP	570	250
		InGaN	470	150
BL-M23A881DUGUB-XX	BL-M23B881DUGUB-XX	GaAlAs/GaAs,DDH	660	310
		AlGaInP	574	380
		InGaN	470	270

BL-M23X881 Series

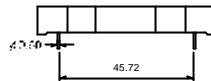
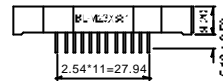
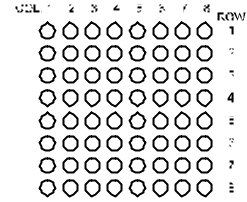
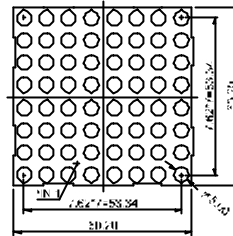

BL-M23A881EG

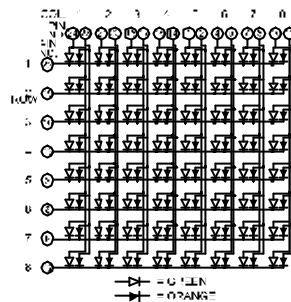

BL-M23B881EG

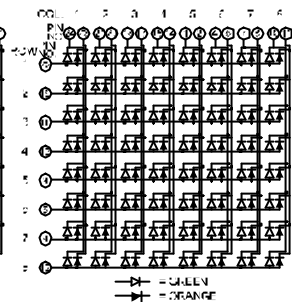

BL-M23C881EG

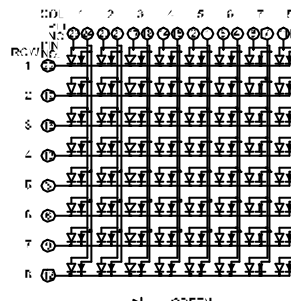

BL-M23D881EG

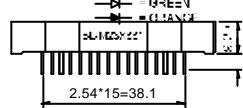
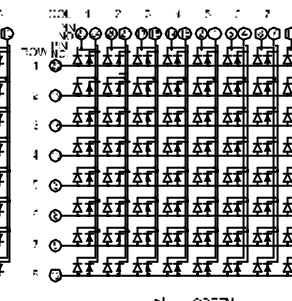

BL-M23B881RGB

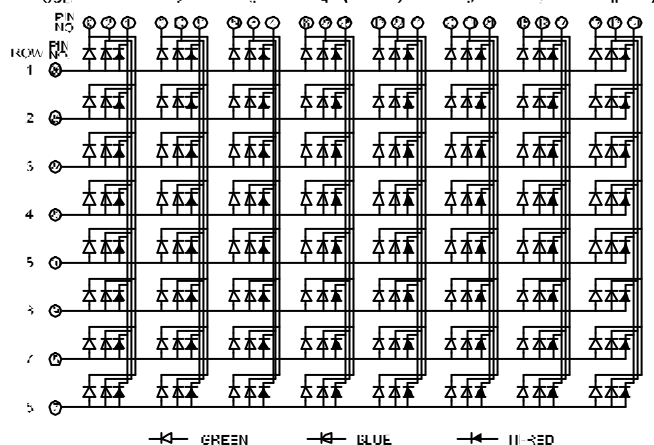

(BL-M23A881RGB C.C.)

Dot Matrix LED Display

Part No		Chip		lv(mcd)	Drawing
CommonCathode	CommonAnode	Material	λP (nm)	Typ.	

BL-M23X881 Series

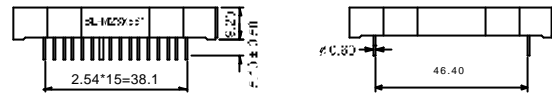
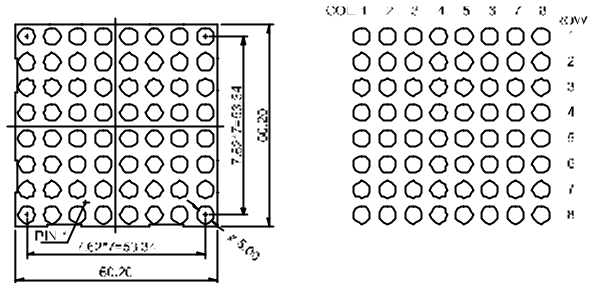

BL-M23D881RGB (BL-M23C881RGB C.C.)

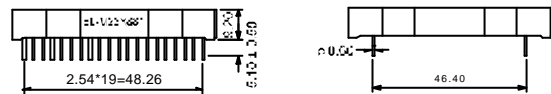
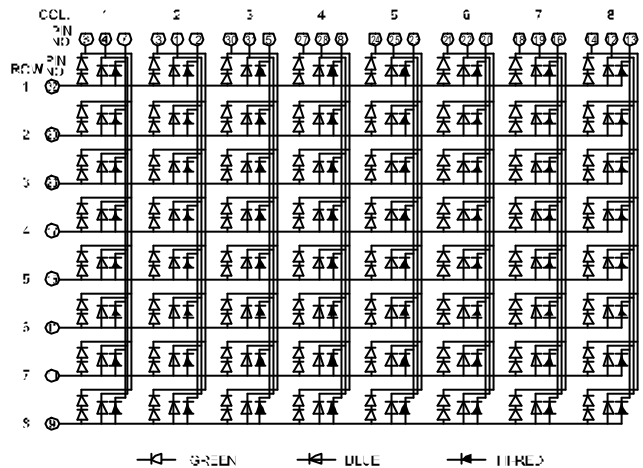

BL-M23F881RGB (BL-M23E881RGB C.C.)

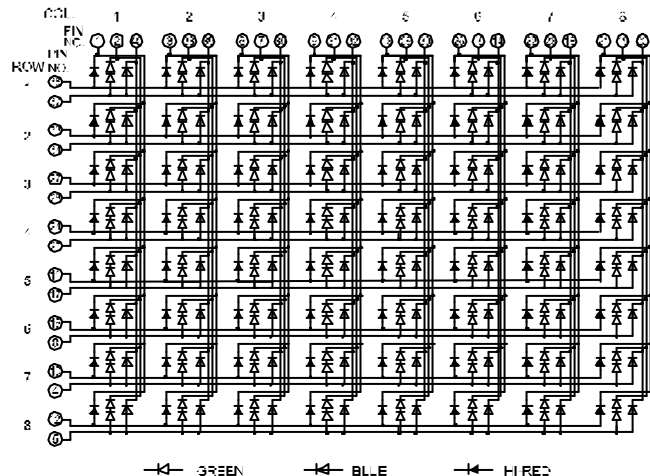

BL-M23C881RGB-XX	BL-M23D881RGB-XX	GaAlAs/GaAs,DH	660	280
		GaP/GaP	570	250
		InGaN	470	150
BL-M23C881DUGUB-XX	BL-M23D881DUGUB-XX	GaAlAs/GaAs,DDH	660	310
		AlGaInP	574	380
		InGaN	470	270

BL-M23E881RGB-XX	BL-M23F881RGB-XX	GaAlAs/GaAs,DH	660	280
		GaP/GaP	570	250
		InGaN	470	150
BL-M23E881DUGUB-XX	BL-M23F881DUGUB-XX	GaAlAs/GaAs,DDH	660	310
		AlGaInP	574	380
		InGaN	470	270

Dot Matrix LED Display

Part No		Chip		Iv(mcd)	Drawing
CommonCathode	CommonAnode	Material	λ P (nm)	Typ.	

BL-ML23A882S-XX	BL-ML23B882S-XX	GaAlAs/GaAs,SH	660	280
BL-ML23A882D-XX	BL-ML23B882D-XX	GaAlAs/GaAs,DH	660	310
BL-ML23A882UR-XX	BL-ML23B882UR-XX	GaAlAs/GaAs,DDH	660	450
BL-ML23A882E-XX	BL-ML23B882E-XX	GaAsP/GaP	635	220
BL-ML23A882Y-XX	BL-ML23B882Y-XX	GaAsP/GaP	585	220
BL-ML23A882G-XX	BL-ML23B882G-XX	GaP/GaP	570	250
BL-ML23A882UHR-XX	BL-ML23B882UHR-XX	AlGaInP	645	450
BL-ML23A882UE-XX	BL-ML23B882UE-XX	AlGaInP	630	255
BL-ML23A882YO-XX	BL-ML23B882YO-XX	AlGaInP	619	255
BL-ML23A882UY-XX	BL-ML23B882UY-XX	AlGaInP	590	255
BL-ML23A882UG-XX	BL-ML23B882UG-XX	AlGaInP	574	380
BL-ML23A882PG-XX	BL-ML23B882PG-XX	InGaN	525	560
BL-ML23A882B-XX	BL-ML23B882B-XX	InGaN	470	270
BL-ML23A882W-XX	BL-ML23B882W-XX	InGaN	/	350

BL-ML23X882

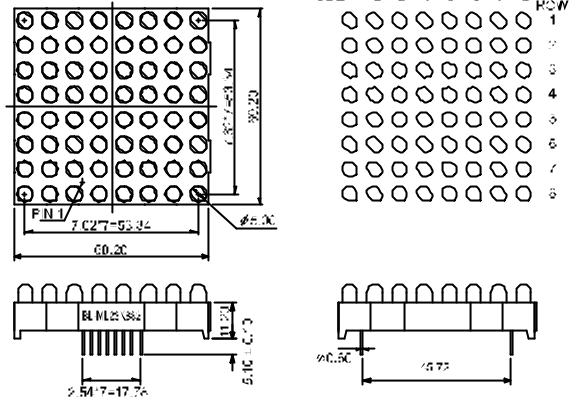

BL-ML23A882

BL-ML23B882

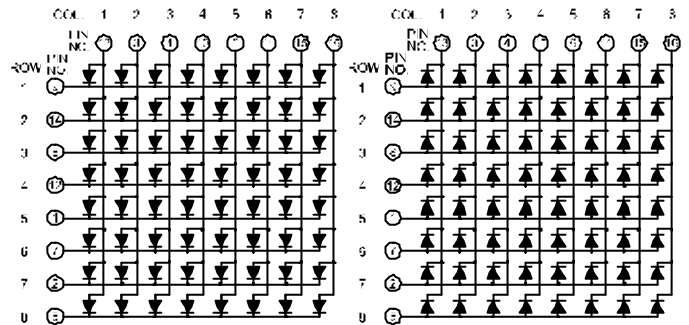

Dot Matrix LED Display

Part No		Chip		λ P (nm)	Typ.
CommonCathode	CommonAnode	Material			
BL-M30A571S-XX	BL-M30B571S-XX	GaAlAs/GaAs,SH	660	140	
BL-M30A571D-XX	BL-M30B571D-XX	GaAlAs/GaAs,DH	660	160	
BL-M30A571UR-XX	BL-M30B571UR-XX	GaAlAs/GaAs,DDH	660	200	
BL-M30A571E-XX	BL-M30B571E-XX	GaAsP/GaP	635	110	
BL-M30A571Y-XX	BL-M30B571Y-XX	GaAsP/GaP	585	110	
BL-M30A571G-XX	BL-M30B571G-XX	GaP/GaP	570	125	
BL-M30A571UHR-XX	BL-M30B571UHR-XX	AlGaInP	645	200	
BL-M30A571UE-XX	BL-M30B571UE-XX	AlGaInP	630	150	
BL-M30A571YO-XX	BL-M30B571YO-XX	AlGaInP	619	150	
BL-M30A571UY-XX	BL-M30B571UY-XX	AlGaInP	590	150	
BL-M30A571UG-XX	BL-M30B571UG-XX	AlGaInP	574	190	
BL-M30A571PG-XX	BL-M30B571PG-XX	InGaN	525	230	
BL-M30A571B-XX	BL-M30B571B-XX	InGaN	470	110	
BL-M30A571W-XX	BL-M30B571W-XX	InGaN	/	190	

BL-M30A571SG-XX	BL-M30B571SG-XX	AlGaInP	660	140
BL-M30A571EG-XX	BL-M30B571EG-XX	GaP/GaP	570	125
BL-M30A571DUG-XX	BL-M30B571DUG-XX	GaAsP/GaP	635	110
		GaP/GaP	570	125
BL-M30A571UEUG-XX	BL-M30B571UEUG-XX	AlGaInP	660	160
		AlGaInP	574	190
		AlGaInP	630	150
		AlGaInP	574	190

Drawing

BL-M30X571 Series

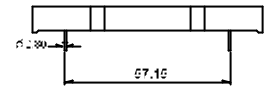
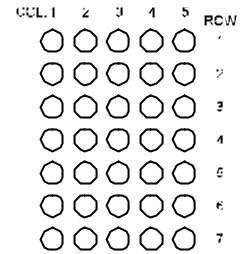
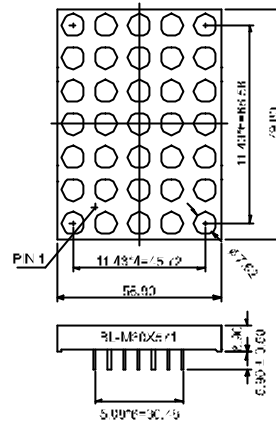

BL-M30A571

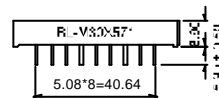
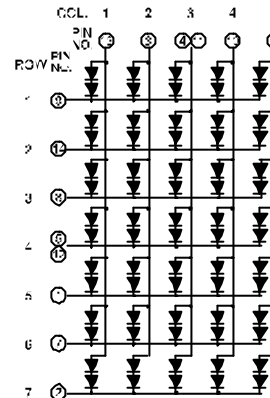

BL-M30B571

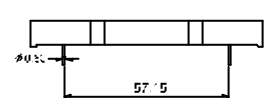
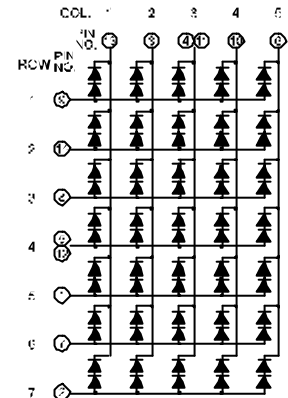

BL-M30A571EG

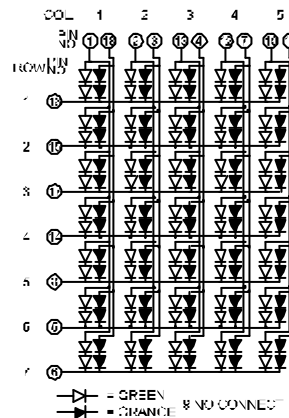

BL-M30B571EG

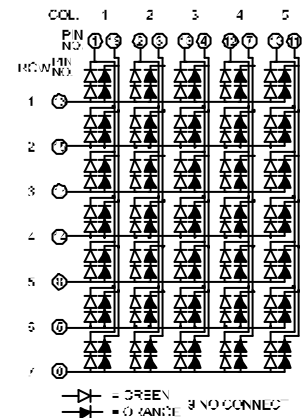

Dot Matrix LED Display

Part No		Chip		λ P (nm)	Typ.
CommonCathode	CommonAnode	Material			

Drawing

BL-M34A581S-XX	BL-M34B581S-XX	GaAlAs/GaAs,SH	█	660	140
BL-M34A581D-XX	BL-M34B581D-XX	GaAlAs/GaAs,DH	█	660	160
BL-M34A581UR-XX	BL-M34B581UR-XX	GaAlAs/GaAs,DDH	█	660	200
BL-M34A581E-XX	BL-M34B581E-XX	GaAsP/GaP	█	635	110
BL-M34A581Y-XX	BL-M34B581Y-XX	GaAsP/GaP	█	585	110
BL-M34A581G-XX	BL-M34B581G-XX	GaP/GaP	█	570	125
BL-M34A581UHR-XX	BL-M34B581UHR-XX	AlGaInP	█	645	200
BL-M34A581UE-XX	BL-M34B581UE-XX	AlGaInP	█	630	150
BL-M34A581YO-XX	BL-M34B581YO-XX	AlGaInP	█	619	150
BL-M34A581UY-XX	BL-M34B581UY-XX	AlGaInP	█	590	150
BL-M34A581UG-XX	BL-M34B581UG-XX	AlGaInP	█	574	190
BL-M34A581PG-XX	BL-M34B581PG-XX	InGaN	█	525	230
BL-M34A581B-XX	BL-M34B581B-XX	InGaN	█	470	110
BL-M34A581W-XX	BL-M34B581W-XX	InGaN	□	/	190

BL-M34X581 Series

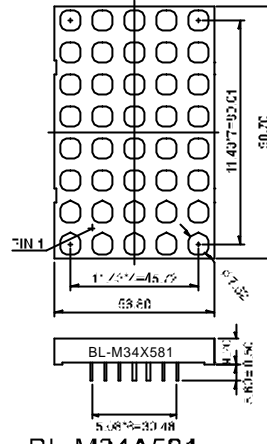

BL-M34A581

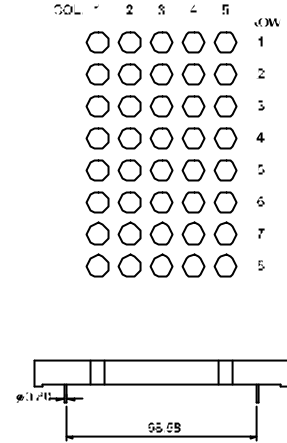

BL-M34B581

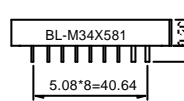
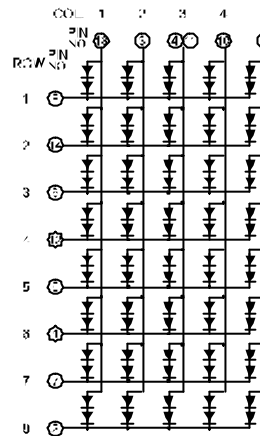

BL-M34A581EG

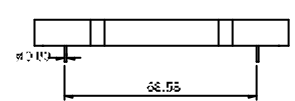
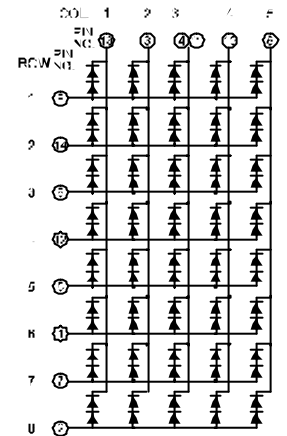

BL-M34B581EG

BL-M34A581SG-XX	BL-M34B581SG-XX	AlGaInP	█	660	140
		GaP/GaP	█	570	125
BL-M34A581EG-XX	BL-M34B581EG-XX	GaAsP/GaP	█	635	110
		GaP/GaP	█	570	125
BL-M34A581DUG-XX	BL-M34B581DUG-XX	AlGaInP	█	660	160
		AlGaInP	█	574	190
BL-M34A581UEUG-XX	BL-M34B581UEUG-XX	AlGaInP	█	630	150
		AlGaInP	█	574	190

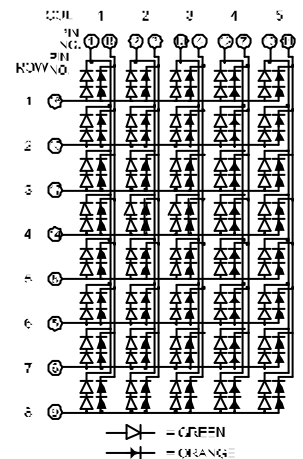
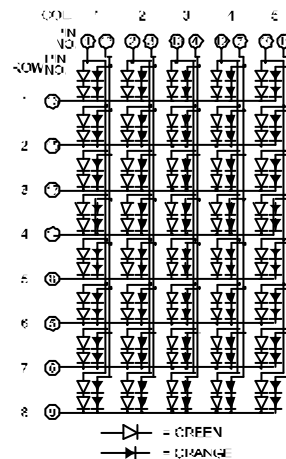

Dot Matrix LED Display

Part No		Chip		λ P (nm)	Typ.
CommonCathode	CommonAnode	Material			
BL-M40A571S-XX	BL-M40B571S-XX	GaAlAs/GaAs,SH	660	155	
BL-M40A571D-XX	BL-M40B571D-XX	GaAlAs/GaAs,DH	660	180	
BL-M40A571UR-XX	BL-M40B571UR-XX	GaAlAs/GaAs,DDH	660	230	
BL-M40A571E-XX	BL-M40B571E-XX	GaAsP/GaP	635	120	
BL-M40A571Y-XX	BL-M40B571Y-XX	GaAsP/GaP	585	120	
BL-M40A571G-XX	BL-M40B571G-XX	GaP/GaP	570	140	
BL-M40A571UHR-XX	BL-M40B571UHR-XX	AlGaInP	645	230	
BL-M40A571UE-XX	BL-M40B571UE-XX	AlGaInP	630	170	
BL-M40A571YO-XX	BL-M40B571YO-XX	AlGaInP	619	170	
BL-M40A571UY-XX	BL-M40B571UY-XX	AlGaInP	590	170	
BL-M40A571UG-XX	BL-M40B571UG-XX	AlGaInP	574	200	
BL-M40A571PG-XX	BL-M40B571PG-XX	InGaN	525	250	
BL-M40A571B-XX	BL-M40B571B-XX	InGaN	470	120	
BL-M40A571W-XX	BL-M40B571W-XX	InGaN	/	200	

BL-M40C571S-XX	BL-M40D571S-XX	GaAlAs/GaAs,SH	660	200
BL-M40C571D-XX	BL-M40D571D-XX	GaAlAs/GaAs,DH	660	232
BL-M40C571UR-XX	BL-M40D571UR-XX	GaAlAs/GaAs,DDH	660	270
BL-M40C571E-XX	BL-M40D571E-XX	GaAsP/GaP	635	180
BL-M40C571Y-XX	BL-M40D571Y-XX	GaAsP/GaP	585	180
BL-M40C571G-XX	BL-M40D571G-XX	GaP/GaP	570	190
BL-M40C571UHR-XX	BL-M40D571UHR-XX	AlGaInP	645	270
BL-M40C571UE-XX	BL-M40D571UE-XX	AlGaInP	630	230
BL-M40C571YO-XX	BL-M40D571YO-XX	AlGaInP	619	230
BL-M40C571UY-XX	BL-M40D571UY-XX	AlGaInP	590	230
BL-M40C571UG-XX	BL-M40D571UG-XX	AlGaInP	574	250
BL-M40C571PG-XX	BL-M40D571PG-XX	InGaN	525	300
BL-M40C571B-XX	BL-M40D571B-XX	InGaN	470	180
BL-M40C571W-XX	BL-M40D571W-XX	InGaN	/	250

BL-M40A571SG-XX	BL-M40B571SG-XX	AlGaInP	660	155
		GaP/GaP	570	140
BL-M40A571EG-XX	BL-M40B571EG-XX	GaAsP/GaP	635	120
		GaP/GaP	570	140
BL-M40A571DUG-XX	BL-M40B571DUG-XX	AlGaInP	660	180
		AlGaInP	574	200
BL-M40A571UEUG-XX	BL-M40B571UEUG-XX	AlGaInP	630	170
		AlGaInP	574	200

Drawing

BL-M40X571 Series

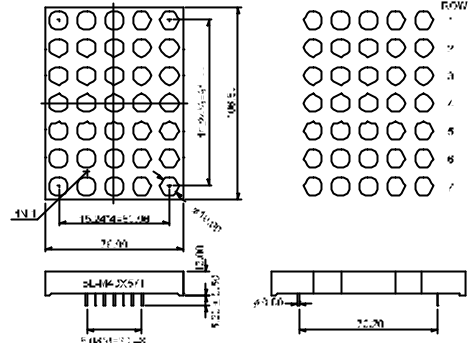

BL-M40A571

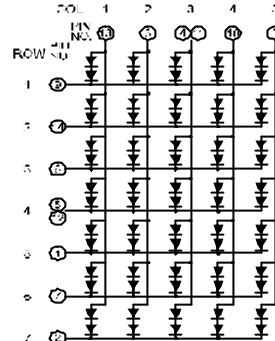

BL-M40B571

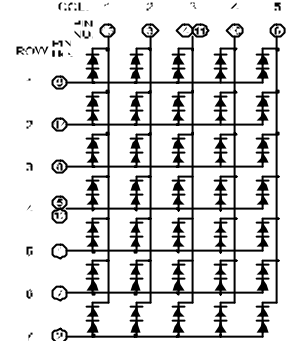

BL-M40C571

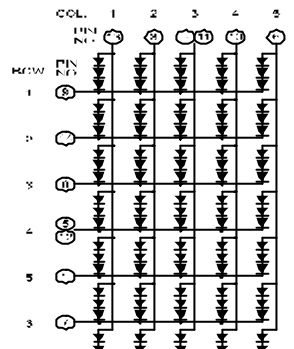

BL-M40D571

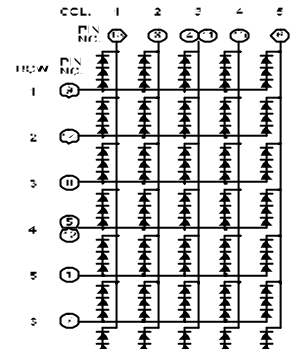

BL-M40A571EG

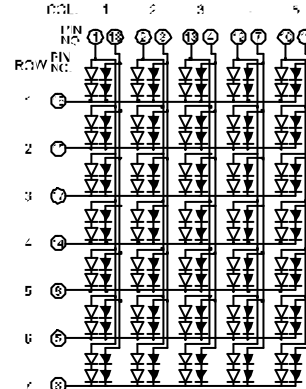

BL-M40B571EG

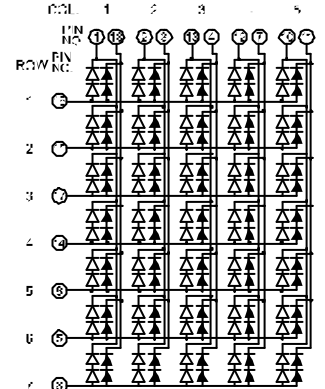

= GREEN
 = OPEN
 = NO CONNECT

= GREEN
 = OPEN
 = NO CONNECT

Dot Matrix LED Display

Part No		Chip		λ P (nm)	Typ.
CommonCathode	CommonAnode	Material			

Drawing

BL-M46A581S-XX	BL-M46B581S-XX	GaAlAs/GaAs,SH	█	660	155
BL-M46A581D-XX	BL-M46B581D-XX	GaAlAs/GaAs,DH	█	660	180
BL-M46A581UR-XX	BL-M46B581UR-XX	GaAlAs/GaAs,DDH	█	660	230
BL-M46A581E-XX	BL-M46B581E-XX	GaAsP/GaP	█	635	120
BL-M46A581Y-XX	BL-M46B581Y-XX	GaAsP/GaP	█	585	120
BL-M46A581G-XX	BL-M46B581G-XX	GaP/GaP	█	570	140
BL-M46A581UHR-XX	BL-M46B581UHR-XX	AlGaInP	█	645	230
BL-M46A581UE-XX	BL-M46B581UE-XX	AlGaInP	█	630	170
BL-M46A581YO-XX	BL-M46B581YO-XX	AlGaInP	█	619	170
BL-M46A581UY-XX	BL-M46B581UY-XX	AlGaInP	█	590	170
BL-M46A581UG-XX	BL-M46B581UG-XX	AlGaInP	█	574	200
BL-M46A581PG-XX	BL-M46B581PG-XX	InGaN	█	525	250
BL-M46A581B-XX	BL-M46B581B-XX	InGaN	█	470	120
BL-M46A581W-XX	BL-M46B581W-XX	InGaN	□	/	200

BL-M46A581SG-XX	BL-M46B581SG-XX	AlGaInP	█	660	155
		GaP/GaP	█	570	140
BL-M46A581EG-XX	BL-M46B581EG-XX	GaAsP/GaP	█	635	120
		GaP/GaP	█	570	140
BL-M46A581DUG-XX	BL-M46B581DUG-XX	AlGaInP	█	660	180
		AlGaInP	█	574	200
BL-M46A581UEUG-XX	BL-M46B581UEUG-XX	AlGaInP	█	630	170
		AlGaInP	█	574	200

BL-M46X581 Series

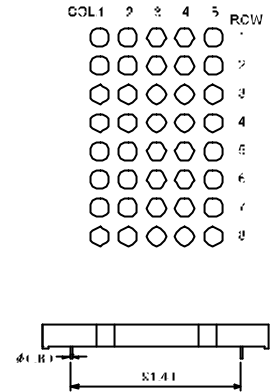
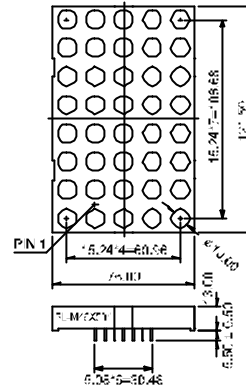

BL-M46A581

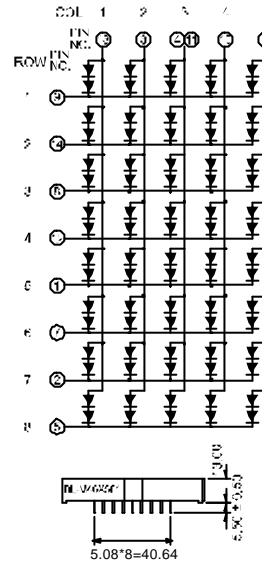

BL-M46B581

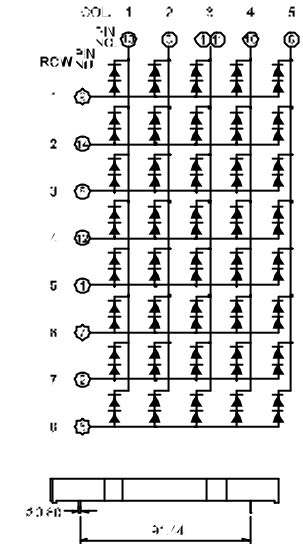

BL-M46A581EG

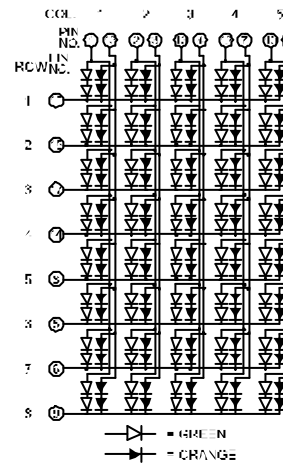

BL-M46B581EG

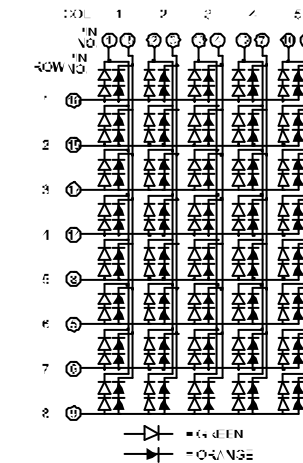

Dot Matrix LED Display

Part No		Chip		Iv(mcd)	Drawing
CommonCathode	CommonAnode	Material	λ_p (nm)	Typ.	

BL-M15AFF1S-XX	BL-M15BFF1S-XX	GaAlAs/GaAs,SH	660	500
BL-M15AFF1D-XX	BL-M15BFF1D-XX	GaAlAs/GaAs,DH	660	750
BL-M15AFF1UR-XX	BL-M15BFF1UR-XX	GaAlAs/GaAs,DDH	660	950
BL-M15AFF1E-XX	BL-M15BFF1E-XX	GaAsP/GaP	635	400
BL-M15AFF1Y-XX	BL-M15BFF1Y-XX	GaAsP/GaP	585	400
BL-M15AFF1G-XX	BL-M15BFF1G-XX	GaP/GaP	570	380
BL-M15AFF1UHR-XX	BL-M15BFF1UHR-XX	AlGaInP	645	950
BL-M15AFF1UE-XX	BL-M15BFF1UE-XX	AlGaInP	630	800
BL-M15AFF1YO-XX	BL-M15BFF1YO-XX	AlGaInP	619	800
BL-M15AFF1UY-XX	BL-M15BFF1UY-XX	AlGaInP	590	800
BL-M15AFF1UG-XX	BL-M15BFF1UG-XX	AlGaInP	574	620
BL-M15AFF1PG-XX	BL-M15BFF1PG-XX	InGaN	525	970
BL-M15AFF1B-XX	BL-M15BFF1B-XX	InGaN	470	360
BL-M15AFF1W-XX	BL-M15BFF1W-XX	InGaN	/	700

BL-M15XFF1 Series

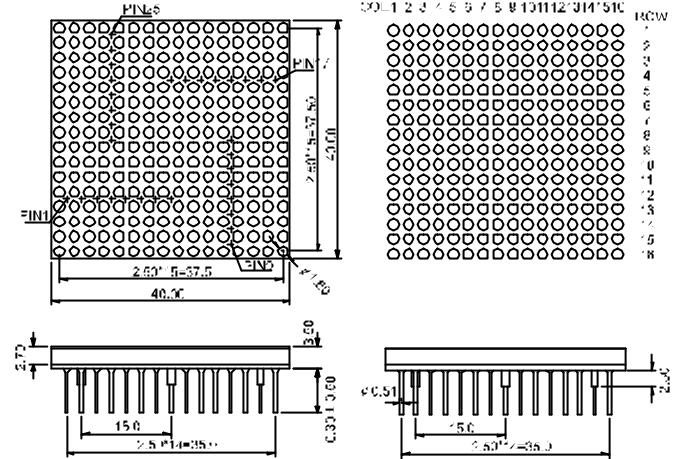

BL-M15BFF1 (BL-M15AFF1 C.C.)

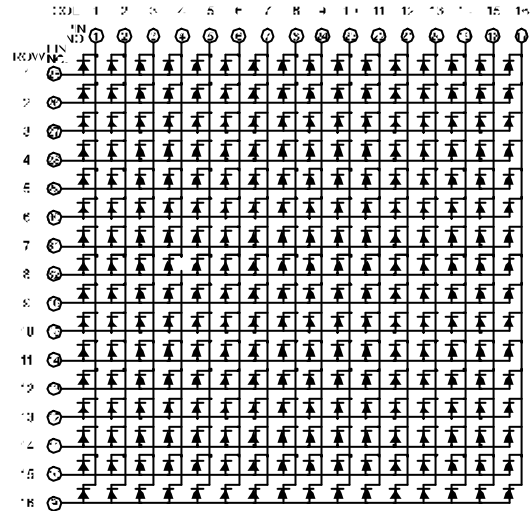

Applicant Note

CAUTIONS on LED Display

1. Cleaning

If cleaning of the display is necessary, gently wipe the surface and the pins out with alcohol or IPA. Use of harsh chemicals might cause corrosion of the pins or result in haze on the surface of the display.

2. Soldering

Solder temperature: Max. 260 for Max. 3 sec. at 1.6mm below seating plane

3. Drive Mode

The displays can be driven in either the constant voltage mode or the constant current mode. Refer to the specifications on maximum allowable drive current in the continuous current mode or the pulse current mode. It is recommended that a current limiting resistor is incorporated in series with each LED.